

DETALII PODETE TUBULARE Ø300 ACCESE CAROSABILE IN CURTI SECTIUNE A-A Scara 1:20

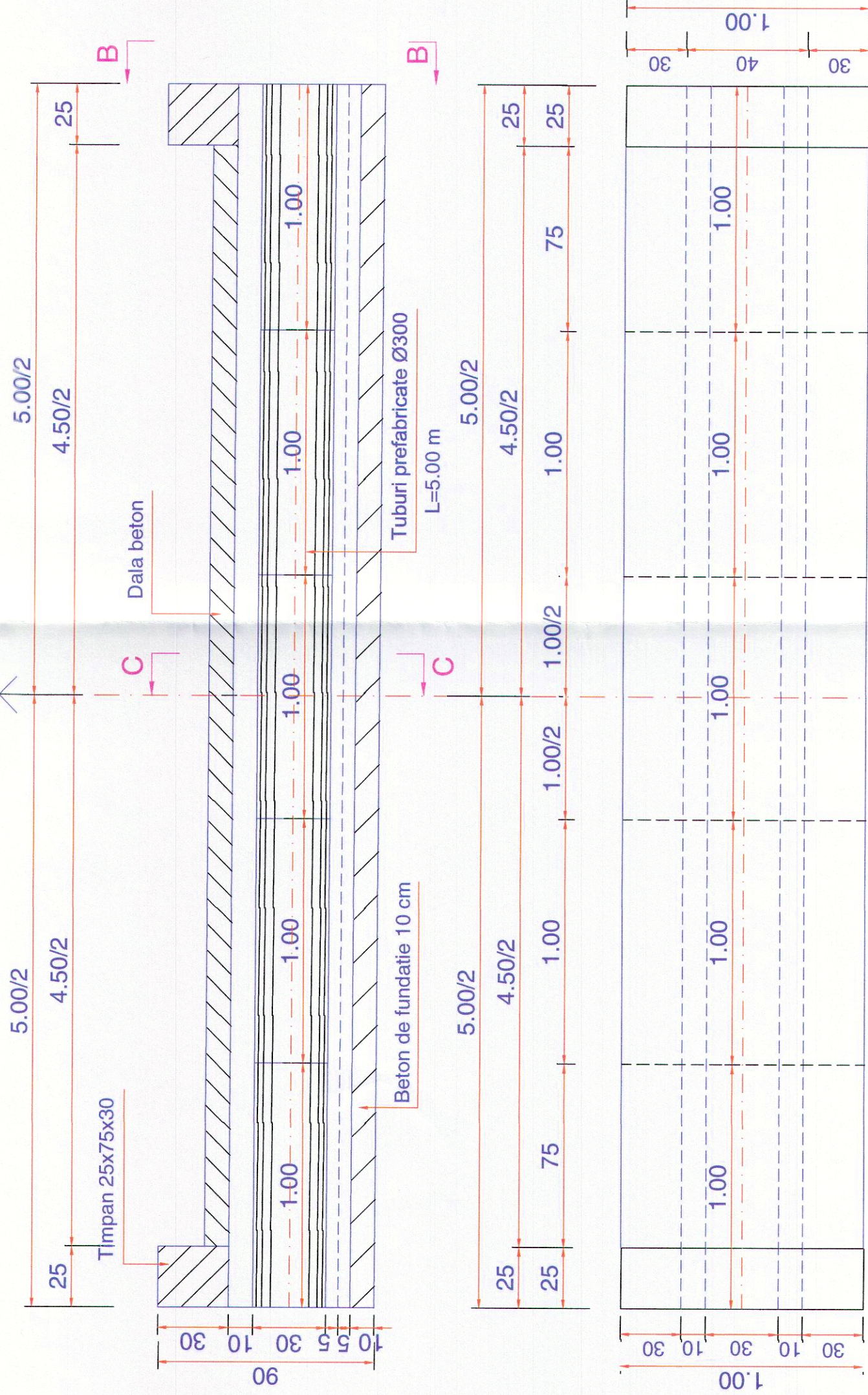

Scara 1:20

VEDERE B-B

SECTIUNE C-C

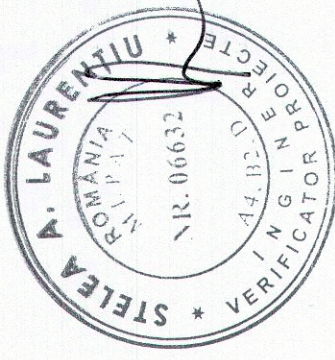
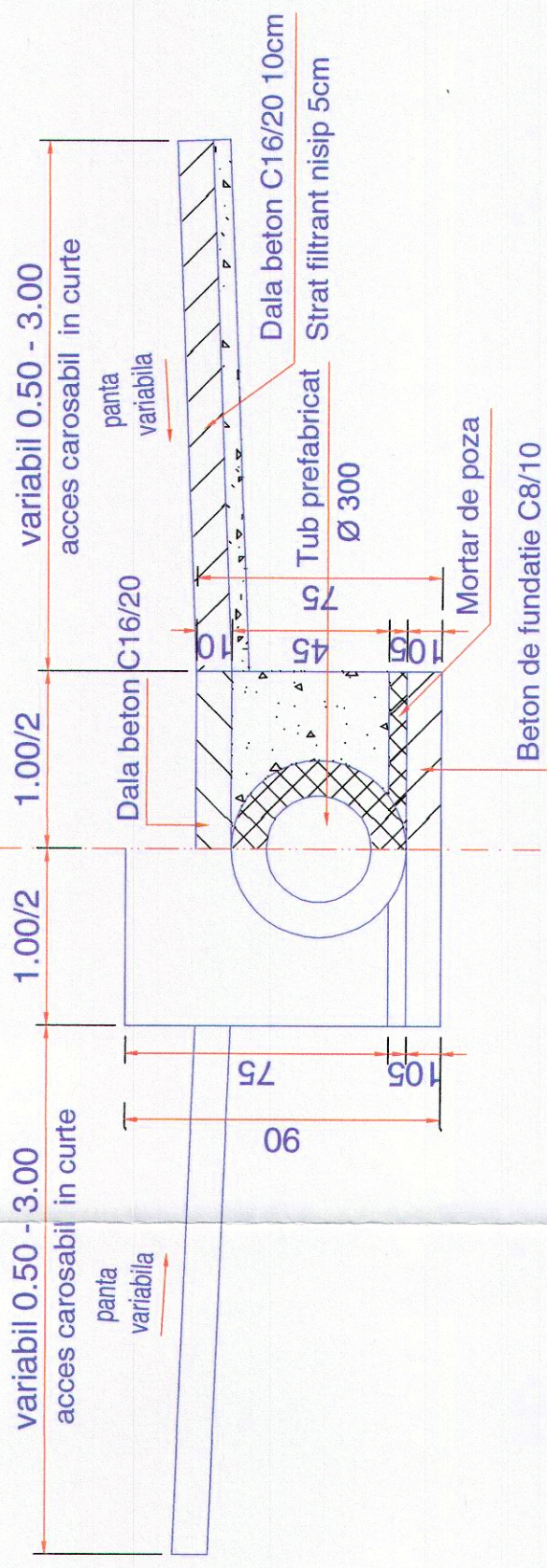

Revizia:	Data:	Numele:	Semnatura:	Motivul revizuirii si documentul:

Nr. proiect: ILCOS 587 / 2015		Investitia: MODERNIZAREA STRAZII CAMINULUI IN COMUNA COSIMBESTI JUDETLUL IALOMITA	
INTERGROUP ENGINEERING			
www.intergroup.ro Sis: J40798/2000 Nr. Inregistrare: RO 13215731 BricsCAD SN: 3444-5268-001-5-33187-7141			
Proiectant	Numele	Semnatura	Data
Verificat	Ing. Alexandru SELAGEA		04.2015
Sef proiect specialitate	Ing. Paul OANCEA		Scara 1:20
Sef proiect complex	Ing. Alexandru SELAGEA		Faza PT
Beneficiar			COMUNA COSIMBESTI, JUDETLUL IALOMITA
Denumire plansa: DETALII PODETE TUBULARE Dn300 LA ACCESE CAROSABILE IN CURTI			
Specialitate: D			Cod plansa: 19

PLAN DE SEMNALIZARE RUTIERA PERMANENTA
SCARA 1:500



Sos. Slobozia Tandarei

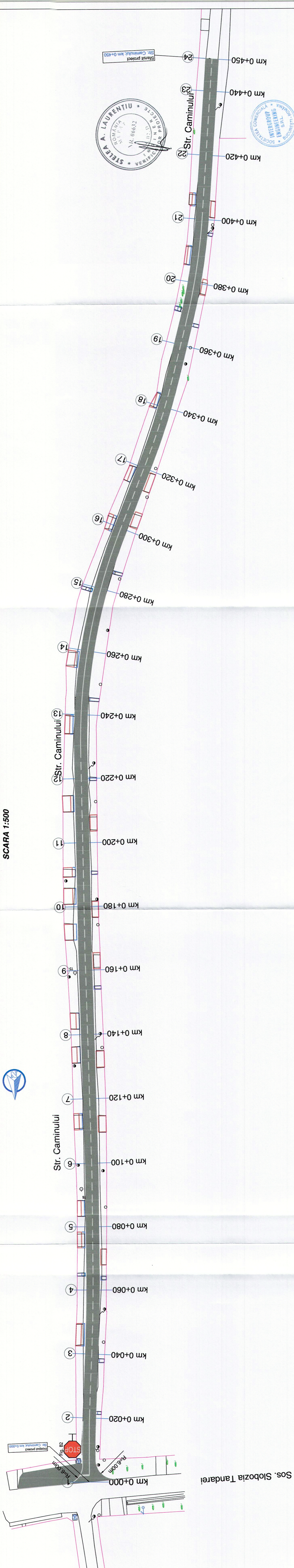

Revizuit:	Data:	Numar:	Numar:	Modul revizuit si documentul:																									
N. proiect: ILCOS 687 / 2015 Investitia: MODERNIZAREA STRAZII CAMINULUI IN COMUNA COSIMBESTI JUDETELUL IALOMITA																													
Proiectant general: <table border="0" style="width: 100%;"> <tr> <td colspan="2"> </td> <td colspan="3"> www.intergroup.ro Str. Slobozia Tandarei, Nr. 12 IALOMITA, ROMANIA </td> </tr> <tr> <td colspan="2"> Proiectant: Ing. Alexandru SELAGEA </td> <td colspan="3"> Data: 03.2015 </td> </tr> <tr> <td colspan="2"> Verificat: Ing. Paul OANCEA </td> <td colspan="3"> Scara: 1:500 </td> </tr> <tr> <td colspan="2"> Sef proiect specializat: Ing. Alexandru SELAGEA </td> <td colspan="3"> Firma: </td> </tr> <tr> <td colspan="2"> Sef proiect complex: Ing. Alexandru SELAGEA </td> <td colspan="3"> P.T.: </td> </tr> </table>							www.intergroup.ro Str. Slobozia Tandarei, Nr. 12 IALOMITA, ROMANIA			Proiectant: Ing. Alexandru SELAGEA		Data: 03.2015			Verificat: Ing. Paul OANCEA		Scara: 1:500			Sef proiect specializat: Ing. Alexandru SELAGEA		Firma:			Sef proiect complex: Ing. Alexandru SELAGEA		P.T.:		
		www.intergroup.ro Str. Slobozia Tandarei, Nr. 12 IALOMITA, ROMANIA																											
Proiectant: Ing. Alexandru SELAGEA		Data: 03.2015																											
Verificat: Ing. Paul OANCEA		Scara: 1:500																											
Sef proiect specializat: Ing. Alexandru SELAGEA		Firma:																											
Sef proiect complex: Ing. Alexandru SELAGEA		P.T.:																											
Beneficiar: COMUNA COSIMBESTI, JUDETELUL IALOMITA																													
Denumire plan: SEMNALIZARE RUTIERA PERMANENTA																													
Cod plan:																													
Specialitate: D																													
Pagina: 21																													

DETALII PODETE TUBULARE Ø300
ACCES PIETONALE IN CURTI
 SECTIUNE A-A
 Scara 1:20

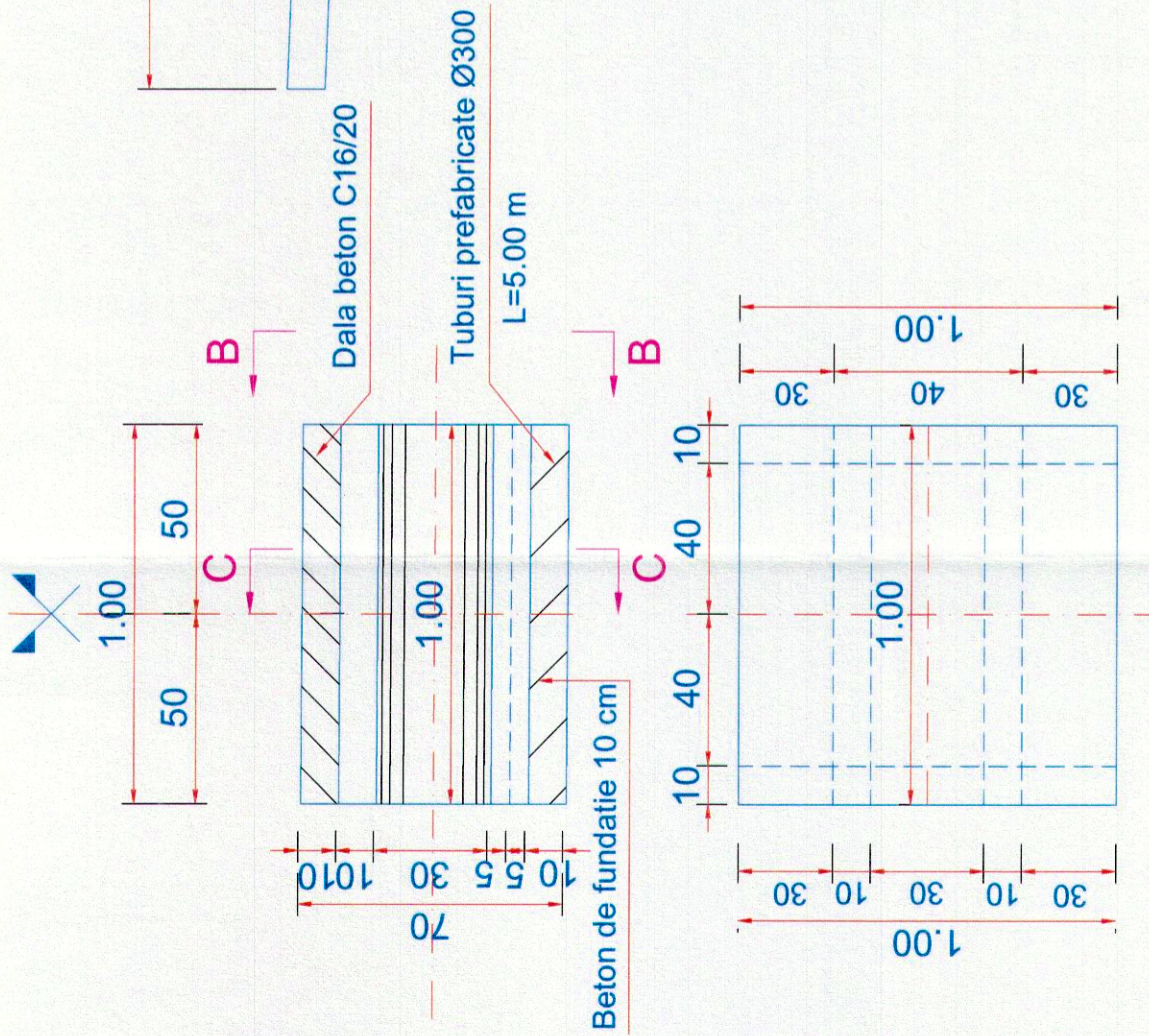

Scara 1:20

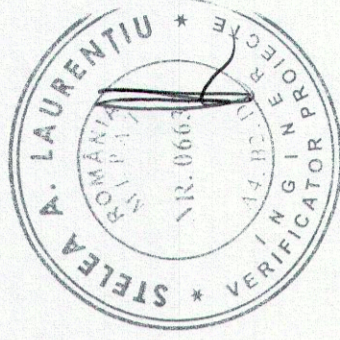
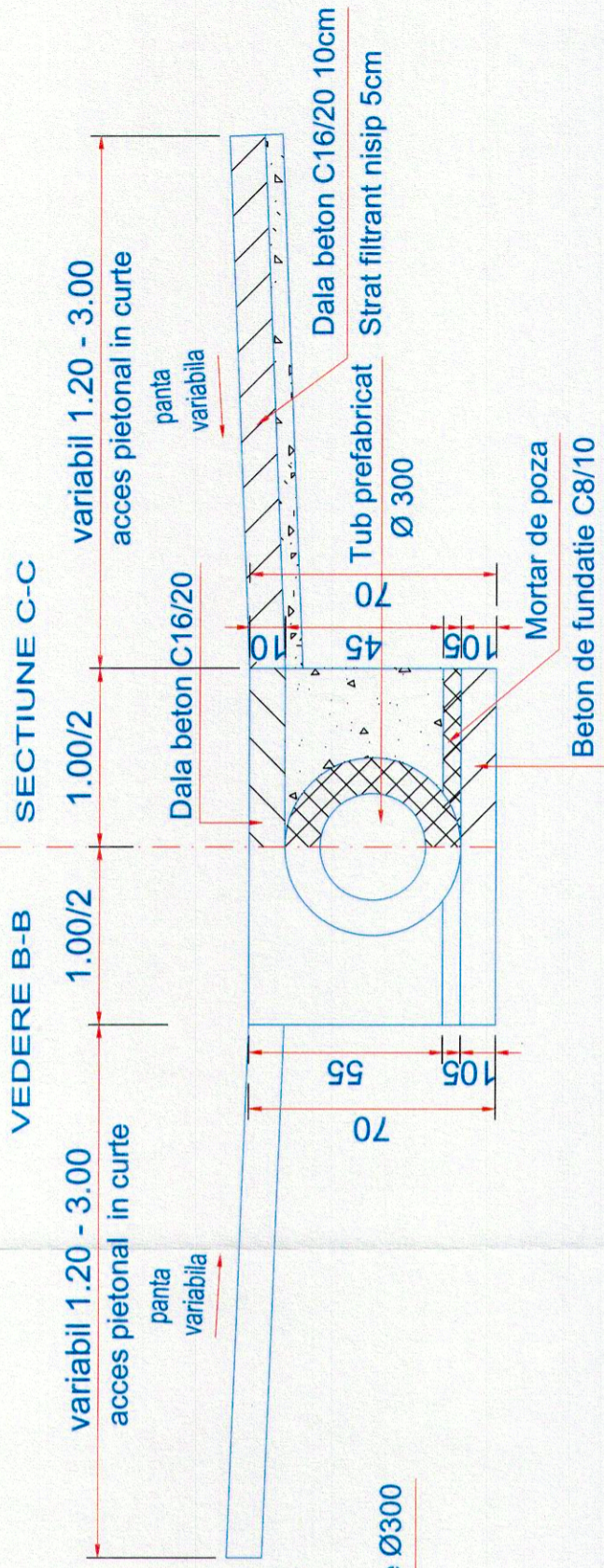

Revizia:	Data:	Numele:	Semnatura:	Motivul revizuirii si documentul:	
Nr. proiect: ILCOS 587 / 2015	Investitia:	MODERNIZAREA STRAZII CAMINULUI IN COMUNA COSIMBESTI JUDETEL IALOMITA			
 Site: www.intergroup.ro Nr. Inregistrare: J40/6798/2000 CUI: RO 13215731 BricCAD SN: 3444-5268-0015-3187-7141					
Proiectant	Numele	Semnatura	Data	Beneficiar	
Verificat	Ing. Alexandru SELAGEA		04.2015	COMUNA COSIMBESTI, JUDETEL IALOMITA	
Sef proiect specialitate	Ing. Paul OANCEA		Scara 1:20		
Sef proiect complex	Ing. Alexandru SELAGEA		Faza PT		
	Ing. Alexandru SELAGEA				
Denumire plansa:				Specialitate: D	Cod plansa: 20
DETALII PODETE TUBULARE Dn300 LA ACCES PIETONALE IN CURTI					

SECTIUNE A-A
scara 1:20

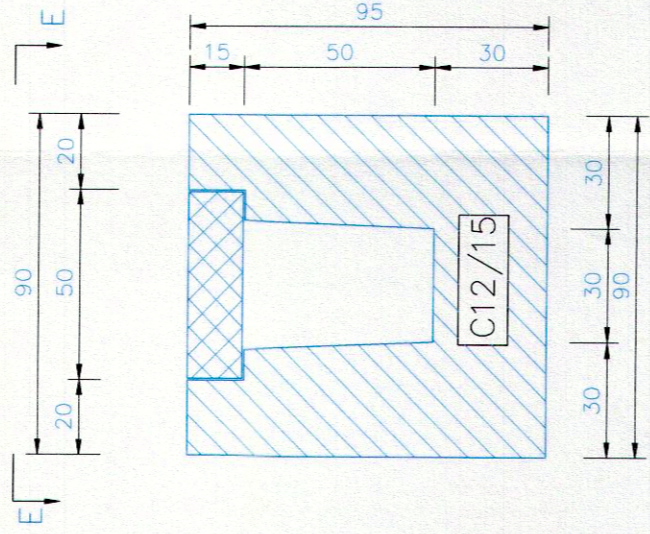

VEDERE B-B
scara 1:20

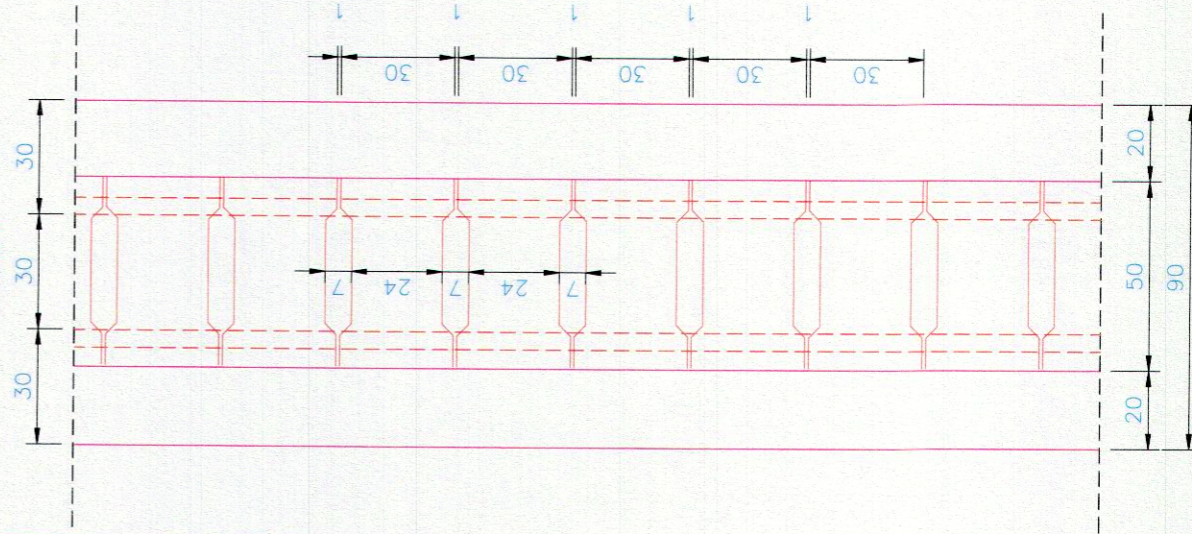

Beton: C16/20; C12/15;
Armatura: OB37

Detalii cofraj placa carosabila prefabricata

SECTIUNE C-C
Scara 1:10

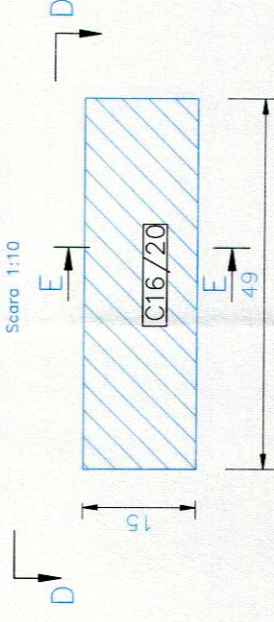

VEDERE D-D
Scara 1:10

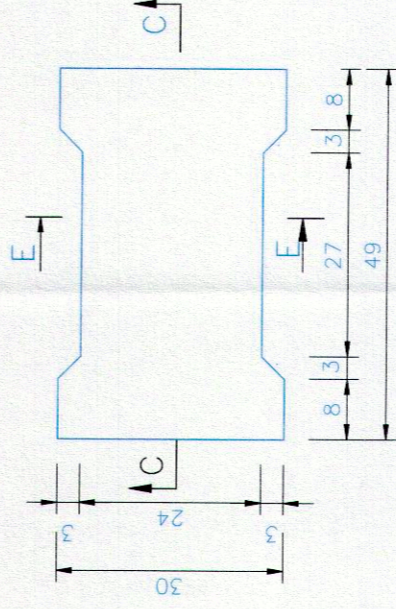

Detalii armare placa carosabila prefabricata

Vedere F-F
Scara 1:10

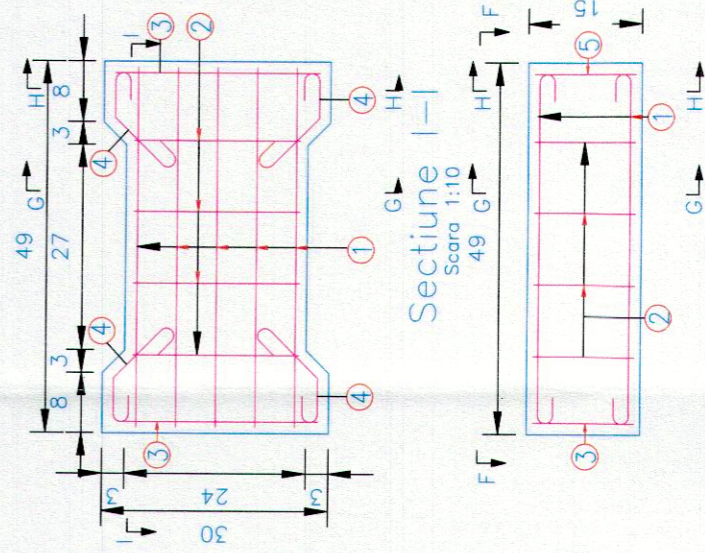

Sectiune I-I
Scara 1:10

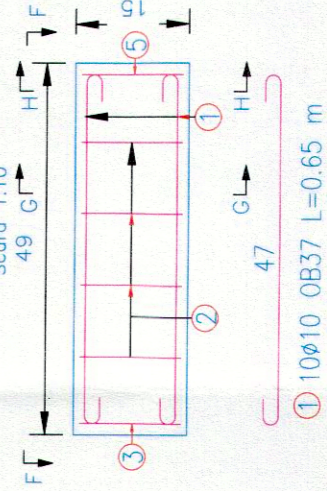

EXTRAS DE MATERIALE PENTRU 1 ML RIGOLA PREFABRICATA
(PLACUTA PREFABRICATA)

TIPUL RIGOLEI	DENUMIRE	VOLUM BETON C16/20	OTEL BETON OB 37	TIPAR METALIC DREPT	ELEMENTE PREFABRICATE
Acoperitia	Placuta carosabila	0,0582	20,70	1,02	3
		mc	kg	mp	buc.

EXTRAS DE ARMATURA PLACUTA CAROSABILA DIN
BETON ARMAT, PENTRU ACOPERIREA RIGOLEI

M	φ	n	L	OB37	
1	10	10	0.65	φ8	
2	8	4	0.75	3.00	
3	8	2	0.90	1.80	
4	8	8	0.30	2.40	
Lungimi/diametre				7.20	6.50
Masa/metru				0.395	0.617
Masa/diametre				2.85	4.05
Masa/ateluri				6.90	
TOTAL pentru 1ml de rigola					20.70kg

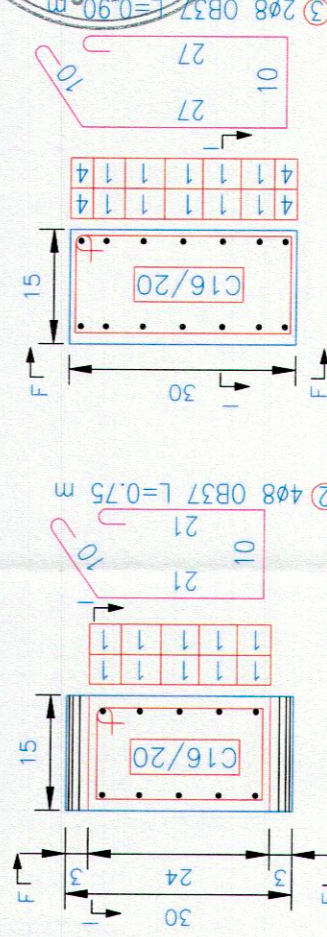

Revizia: Data: Numerele: Semnatura: Motivul revizurii si documentul:

Nr. proiect: ILCOS 587 / 2015 Investitia: MODERNIZAREA STRAZII CAMINULUI IN COMUNA COSIMBESTI JUDETEL IALOMITA

Beneficiar: **COMUNA COSIMBESTI, JUDETEL IALOMITA**

Proiectant general: **INTERGROUP ENGINEERING**
 Site: www.intergroup.ro
 Nr. Inregistrare: J406798/2000
 CUI: RO 13215731
 BricCAD SN: 3444-5268-0015-33187-7141

Proiectant	Numerele	Scara	Data
Ing. Alexandru SELAGEA		04,2015	
Ing. Paul OANCEA		1,20,1:10	
Ing. Alexandru SELAGEA		Faza	PT
Ing. Alexandru SELAGEA			

Denumire plansa: **DETALII RIGOLA CAROSABILA**

Specialitate: D Cod plansa: 18

PROFILE TRANSVERSALE CURENTE
SCARA 1:100

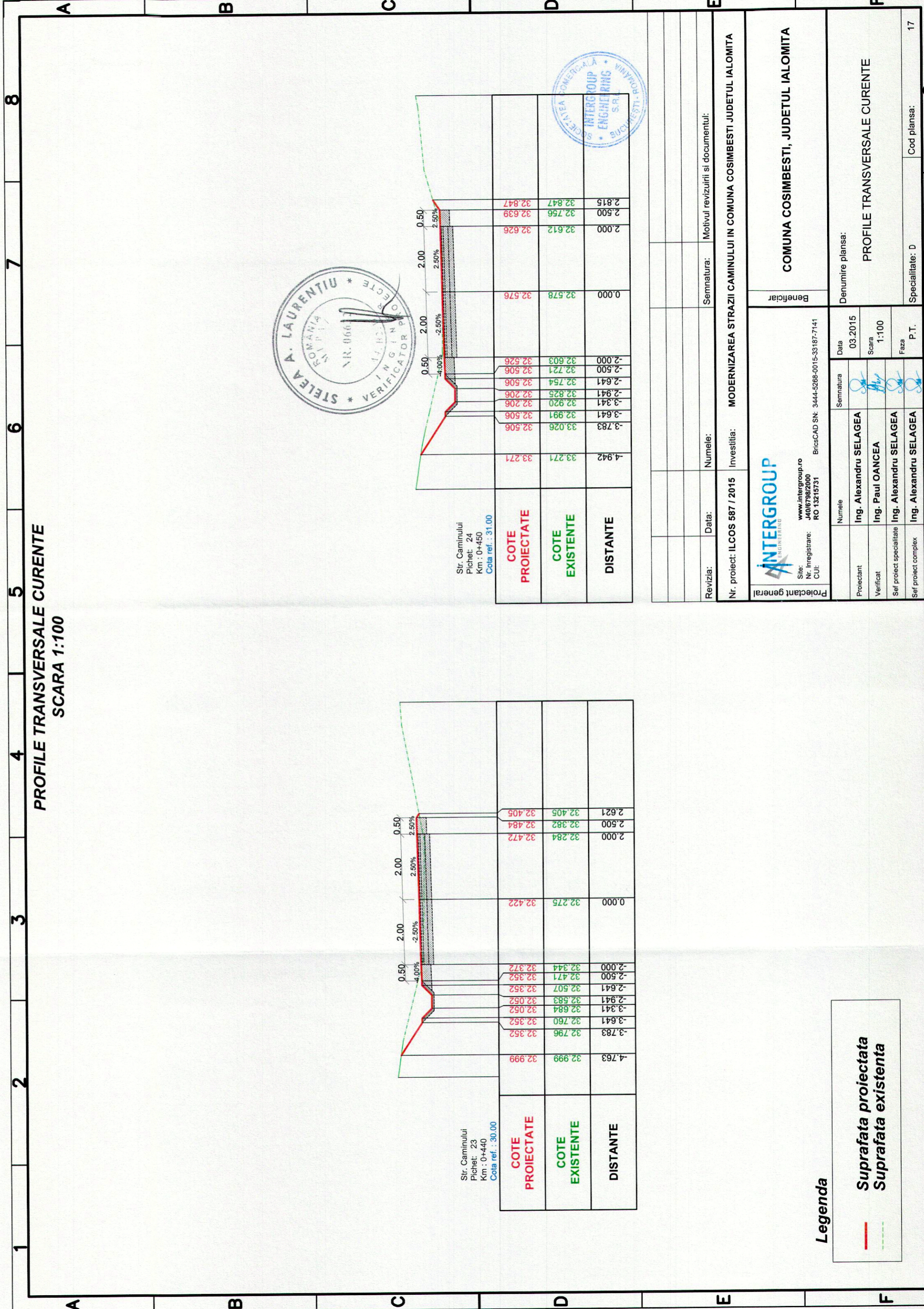

Str. Caminului
Pichet: 23
Km : 0+440
Cota ref. : 30.00

COTE PROIECTATE	COTE EXISTENTE	DISTANTE
32.999	32.999	-4.763
32.352	32.796	-3.783
32.052	32.760	-3.641
32.052	32.684	-3.341
32.052	32.583	-2.941
32.352	32.507	-2.641
32.352	32.471	-2.500
32.372	32.344	-2.000
32.422	32.275	0.000
32.472	32.284	2.000
32.484	32.382	2.500
32.405	32.405	2.621

Str. Caminului
Pichet: 24
Km : 0+450
Cota ref. : 31.00

COTE PROIECTATE	COTE EXISTENTE	DISTANTE
33.271	33.026	-3.783
32.991	32.991	-3.641
32.206	32.920	-3.341
32.206	32.825	-2.941
32.506	32.754	-2.641
32.506	32.721	-2.500
32.526	32.603	-2.000
32.576	32.578	0.000
32.626	32.612	2.000
32.639	32.756	2.500
32.847	32.847	2.815

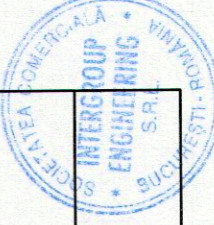
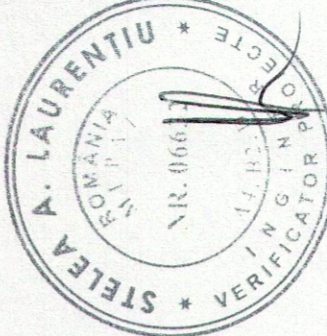

Legenda

- Suprafata proiectata
- - - Suprafata existenta

Revizia:	Data:	Numele:	Semnatura:	Motivul revizurii si documentul:
Nr. proiect: ILCOS 587 / 2015 Investitia: MODERNIZAREA STRAZII CAMINULUI IN COMUNA COSIMBESTI JUDETUL IALOMITA				
Beneficiar: COMUNA COSIMBESTI, JUDETUL IALOMITA				
Proiectant general		Proiectant general		
Site: www.intergroup.ro		BricsCAD SN: 3444-5268-0015-33187-7141		
Nr. Inregistrare: J4016798/2000		Data: 03.2015		
CUJ: RO 13215731		Scara: 1:100		
Faza: P.T.		Specialitate: D		
Cod plansa: 17				8

**PROFILE TRANSVERSALE CURENTE
SCARA 1:100**

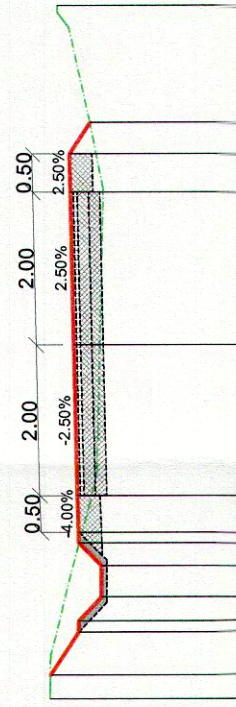

Str. Caminului
Pichet: 20
Km : 0+380
Cota ref. : 28.00

COTE PROIECTATE	COTE EXISTENTE	DISTANTE
30.538	30.457	30.165
30.420	30.420	30.165
30.341	30.341	29.865
30.236	30.236	29.865
30.158	30.158	30.165
30.121	30.121	30.165
29.995	29.995	30.165
29.891	29.891	30.235
29.851	29.851	30.285
29.946	29.946	30.298
30.029	30.029	30.029
2.908		

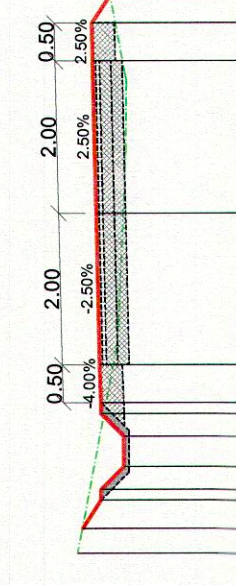

Str. Caminului
Pichet: 22
Km : 0+420
Cota ref. : 30.00

COTE PROIECTATE	COTE EXISTENTE	DISTANTE
32.135	32.065	31.890
31.890	31.890	31.890
31.590	31.590	31.890
31.341	31.341	31.890
31.252	31.252	31.890
30.978	30.978	31.890
30.861	30.861	31.890
31.161	31.161	31.890
31.161	31.161	31.890
31.161	31.161	31.890
31.161	31.161	31.890
30.881	30.881	31.181
30.929	30.929	31.161
30.829	30.829	31.161
30.894	30.894	31.231
30.920	30.920	31.281
31.008	31.293	31.065
31.065	31.065	31.065
2.846		

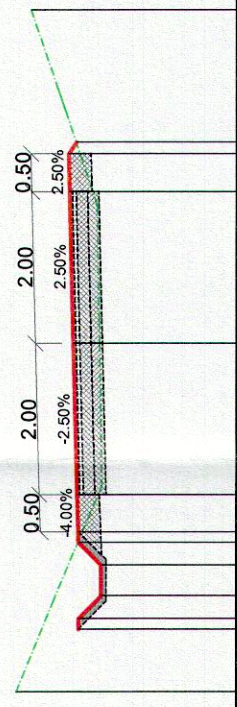

Str. Caminului
Pichet: 19
Km : 0+360
Cota ref. : 27.00

COTE PROIECTATE	COTE EXISTENTE	DISTANTE
29.093	29.577	3.783
29.093	29.519	3.641
28.793	28.793	3.341
28.793	28.793	3.341
28.793	28.793	3.341
28.793	28.793	3.341
28.829	28.829	2.909
29.093	29.093	2.641
29.093	29.093	2.641
29.093	29.093	2.641
29.093	29.093	2.641
29.113	29.113	2.500
29.093	29.093	2.500
29.040	29.040	2.500
29.126	29.126	2.912
29.213	29.213	2.913
28.813	28.813	0.000
28.906	28.906	2.000
29.075	29.075	2.500
29.126	29.126	2.651

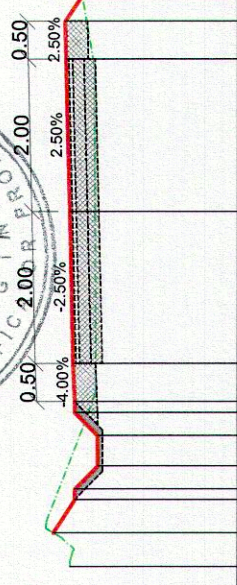

Str. Caminului
Pichet: 21
Km : 0+400
Cota ref. : 29.00

COTE PROIECTATE	COTE EXISTENTE	DISTANTE
31.445	31.445	4.213
31.425	31.425	3.783
31.370	31.370	3.641
31.252	31.252	3.341
30.978	30.978	2.941
30.861	30.861	2.941
30.861	30.861	2.941
31.161	31.161	2.641
31.161	31.161	2.641
31.161	31.161	2.641
31.161	31.161	2.641
31.181	31.181	2.000
30.881	30.881	2.000
30.929	30.929	2.500
30.829	30.829	2.500
30.894	30.894	0.000
30.920	30.920	2.000
31.281	31.281	2.000
31.293	31.293	2.500
31.065	31.065	2.846

Legenda

— Suprafata proiectata
- - - Suprafata existenta

Revizia: Data: Numele: Semnatura: Motivul revizurii si documentul:

Nr. proiect: ILCOS 587 / 2015 Investitia: MODERNIZAREA STRAZII CAMINULUI IN COMUNA COSIMBESTI JUDETELUL IALOMITA

Proiectant general

INTERGROUP
www.intergroup.ro
Sire: J40/6798/2000
Nr. Inregistrare: RO 13215731
CUI: BricCAD SN: 3444-5268-0015-33167-7141

Beneficiar
COMUNA COSIMBESTI, JUDETELUL IALOMITA

Numele
Ing. Alexandru SELAGEA
Ing. Paul OANCEA
Ing. Alexandru SELAGEA
Ing. Alexandru SELAGEA

Denumire plansa:
PROFILE TRANSVERSALE CURENTE

Specialitate: D Cod plansa: 16

PROFILE TRANSVERSALE CURENTE
SCARA 1:100

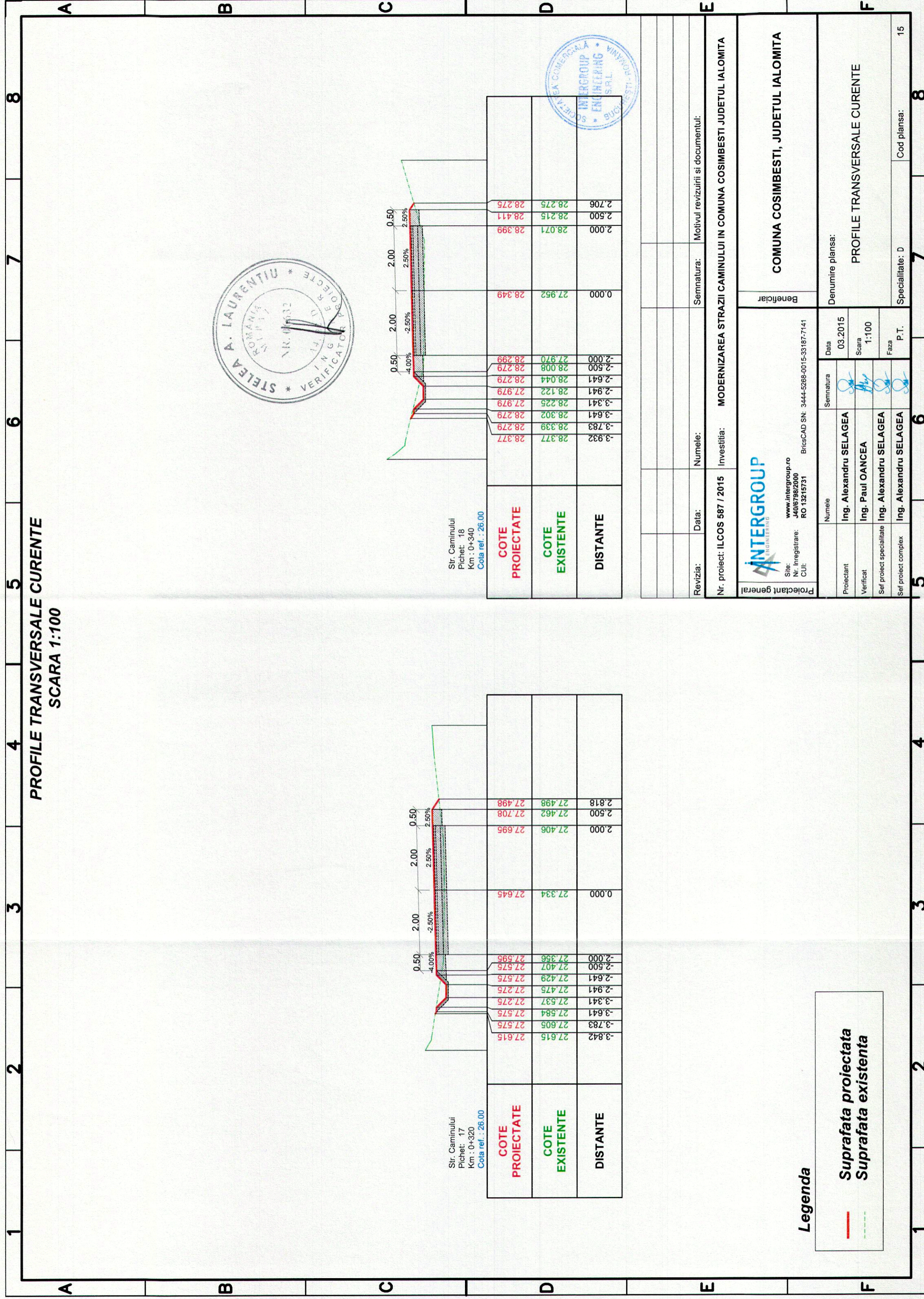

Str. Caminului
Pictet : 17
Km : 0+320
Cota ref. : 26.00

COTE PROIECTATE	COTE EXISTENTE	DISTANTE
27.615	27.615	-3.842
27.615	27.605	-3.783
27.575	27.575	-3.641
27.575	27.584	-3.641
27.275	27.537	3.341
27.275	27.537	3.341
27.275	27.475	-2.941
27.275	27.429	-2.641
27.575	27.407	-2.500
27.575	27.356	-2.000
27.595	27.356	-2.000
27.645	27.334	0.000
27.695	27.406	2.000
27.708	27.462	2.500
27.498	27.498	2.818

Str. Caminului
Pictet : 18
Km : 0+340
Cota ref. : 26.00

COTE PROIECTATE	COTE EXISTENTE	DISTANTE
28.377	28.377	-3.932
28.379	28.339	-3.783
28.279	28.302	-3.641
28.279	28.225	-3.341
27.979	28.122	-2.941
28.279	28.044	-2.641
28.279	28.008	-2.500
28.279	27.970	-2.000
28.299	27.970	-2.000
28.349	27.952	0.000
28.399	28.071	2.000
28.411	28.215	2.500
28.275	28.275	2.706

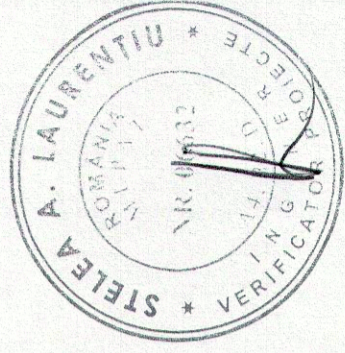

Legenda

- Suprafata proiectata
- - - Suprafata existenta

Revizia:	Data:	Numele:	Semnatura:	Motivul revizuirii si documentul:
Nr. proiect: ILCOS 587 / 2015 Investitia: MODERNIZAREA STRAZII CAMINULUI IN COMUNA COSIMBESTI JUDETLUL IALOMITA				
Beneficiar				
COMUNA COSIMBESTI, JUDETLUL IALOMITA				
Proiectant general				
Site: www.intergroup.ro Nr. inregistrare: 0015742300 CUI: RO 13215731 BricCAD SN: 3444-5268-0015-33187-7141				
Proiectant	Numele	Semnatura	Data	
Verificat	Ing. Alexandru SELAGEA		03.2015	
Sef proiect specialitate	Ing. Paul OANCEA		Scara	1:100
Sef proiect complex	Ing. Alexandru SELAGEA		Faza	P.T.
				Specialitate: D
				Cod plansa: 15

PROFILE TRANSVERSALE CURENTE
SCARA 1:100

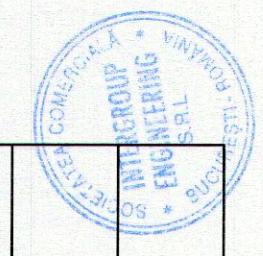
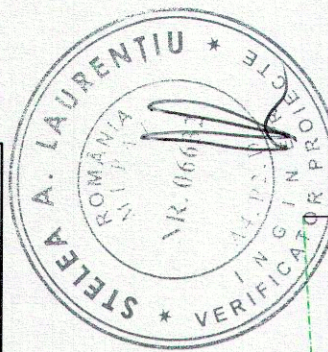
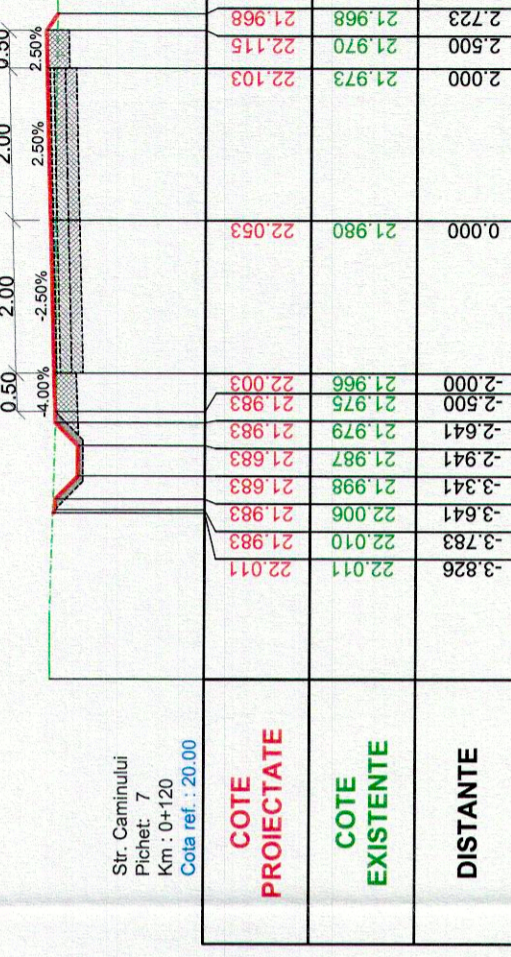
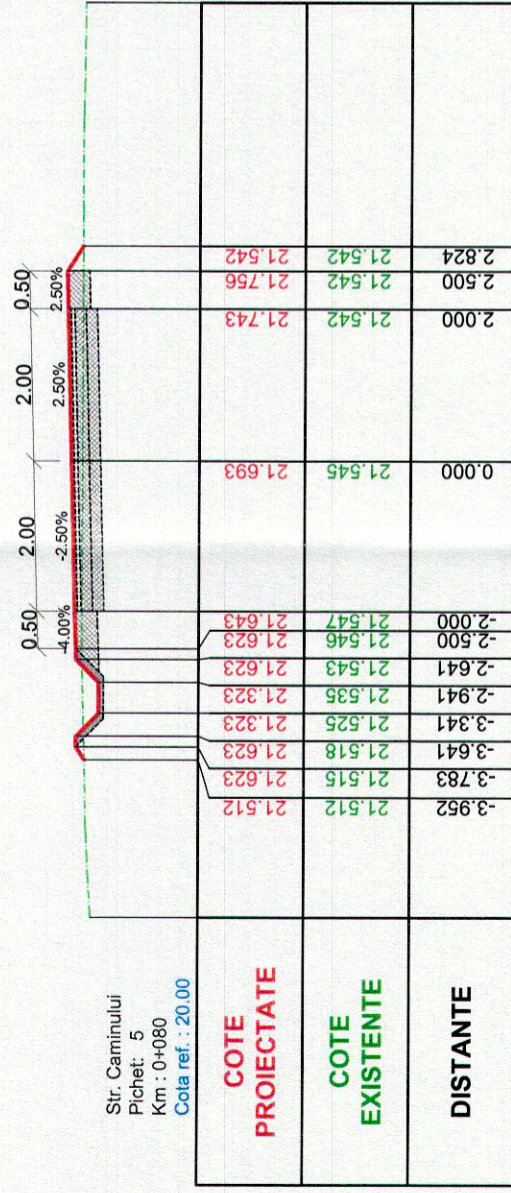
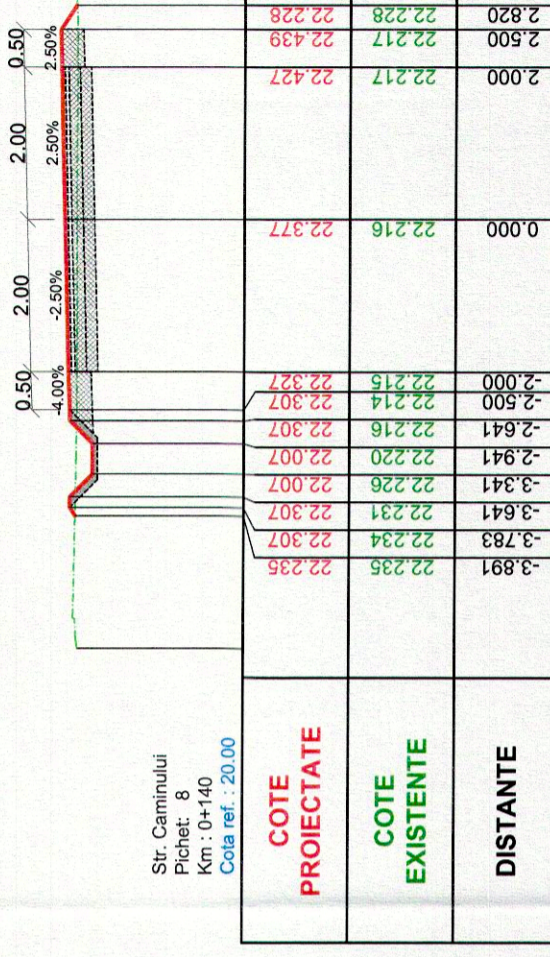
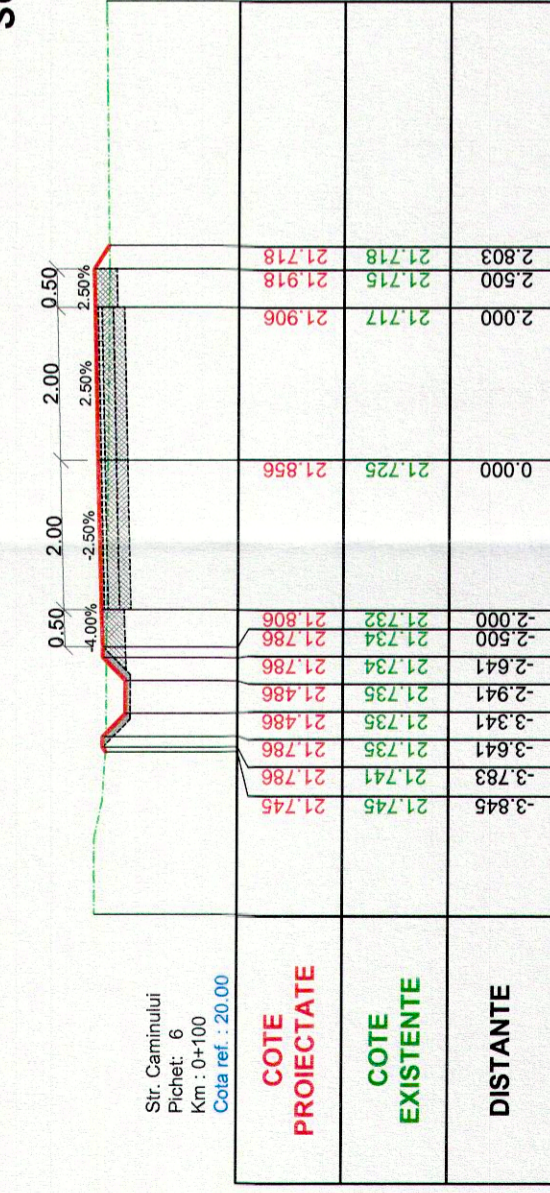

Legenda

— Suprafata proiectata
- - - Suprafata existenta

Revizia: Data: Numele: Semnatura: Motivul revizurii si documentul:

Nr. proiect: ILCOS 587 / 2015 Investitia: MODERNIZAREA STRAZII CAMINULUI IN COMUNA COSIMBESI JUDETLUL IALOMITA

Proiectant general
INTERGROUP ENGINEERING

Site: www.intergroup.ro
Nr. Inregistrare: J40/6798/2000
CUI: RO 13215731
BricsCAD SN: 3444-5268-0015-33187-7141

Beneficiar
COMUNA COSIMBESI, JUDETLUL IALOMITA

Numele
Ing. Alexandru SELAGEA
Ing. Paul OANCEA
Ing. Alexandru SELAGEA
Ing. Alexandru SELAGEA

Semnatura
[Signature]
[Signature]
[Signature]
[Signature]

Data
03.2015
Scara
1:100
Faza
P.T.

Denumire plansa:
PROFILE TRANSVERSALE CURENTE

Specialitate: D Cod plansa: 12

**PROFILE TRANSVERSALE CURENTE
SCARA 1:100**

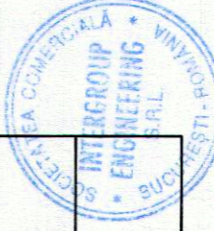
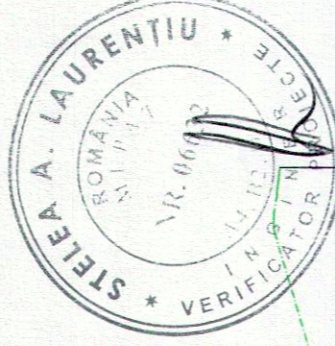
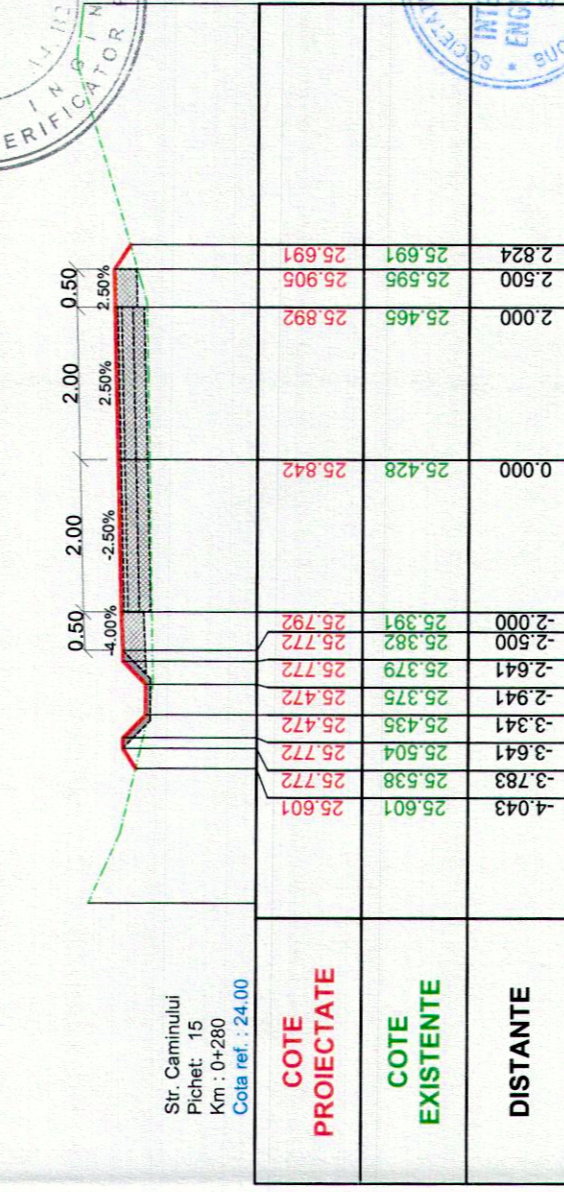
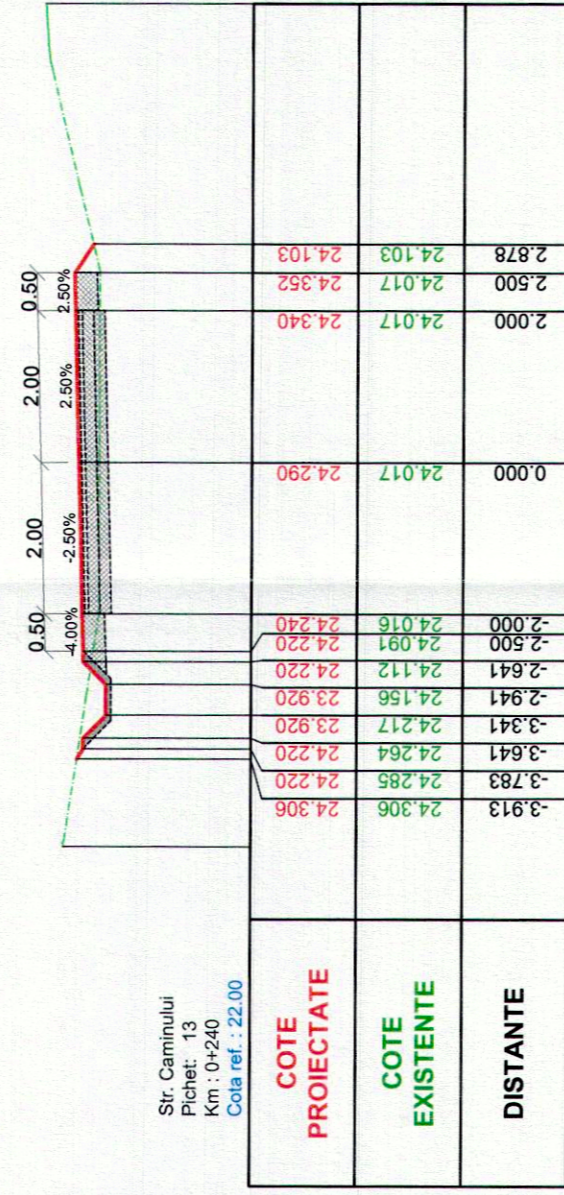
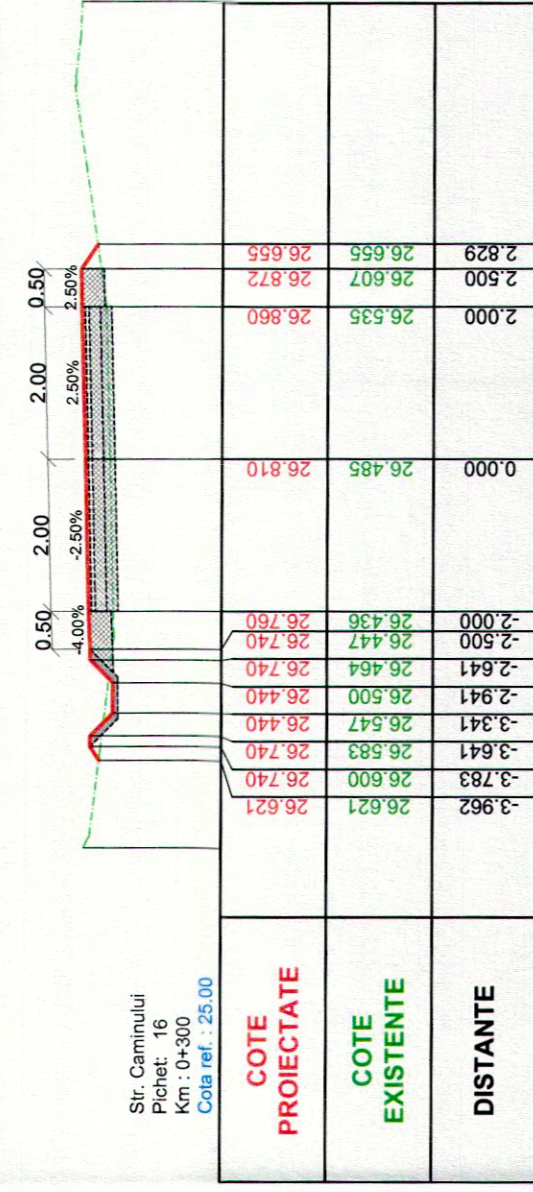
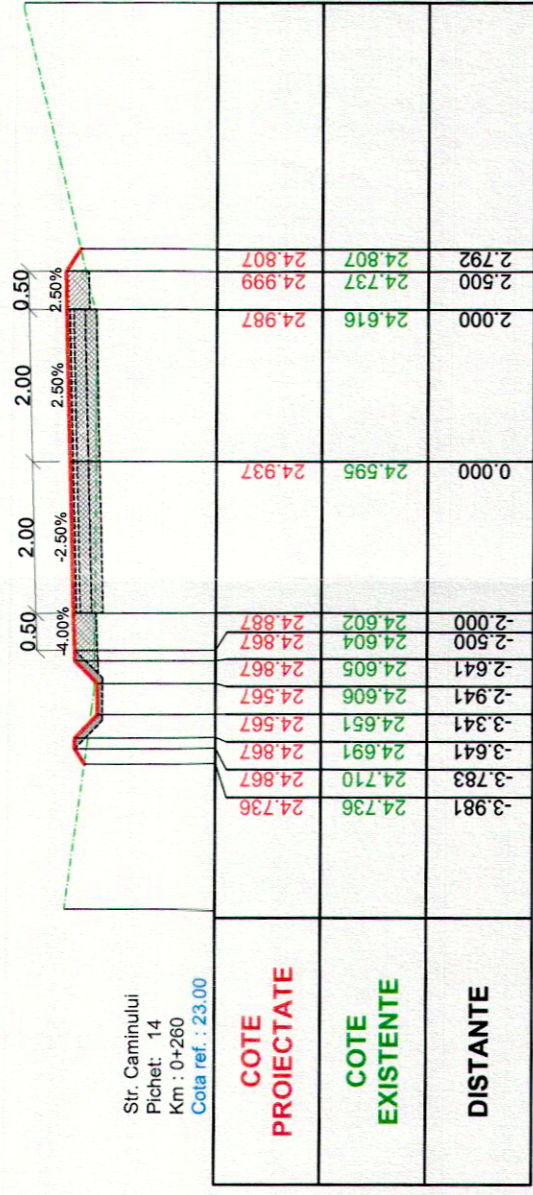

Legenda

— Suprafata proiectata
- - - Suprafata existenta

Revizia:	Data:	Numele:	Semnatura:	Motivul revizurii si documentul:

Nr. proiect: LCOS 587 / 2015 Investitia: MODERNIZAREA STRAZII CAMINULUI IN COMUNA COSIMBESTI JUDETEL IALOMITA

INTERGROUP ENGINEERING
 www.intergroup.ro
 Nr. Inregistrare: J4067982/2000
 CUI: RO 13215731
 BricCAD SN: 3444-5268-0015-33187-7141

Beneficiar		Denumire plansa:	
COMUNA COSIMBESTI, JUDETEL IALOMITA		PROFILE TRANSVERSALE CURENTE	
Proiectant	Numele	Semnatura	Data
Verificat	Ing. Alexandru SELAGEA		03.2015
Sef proiect specialitate	Ing. Paul OANCEA		Scara 1:100
Sef proiect complex	Ing. Alexandru SELAGEA		Faza P. T.
	Ing. Alexandru SELAGEA		Specialitate: D
			Cod plansa: 14

**PROFILE TRANSVERSALE CURENTE
SCARA 1:100**

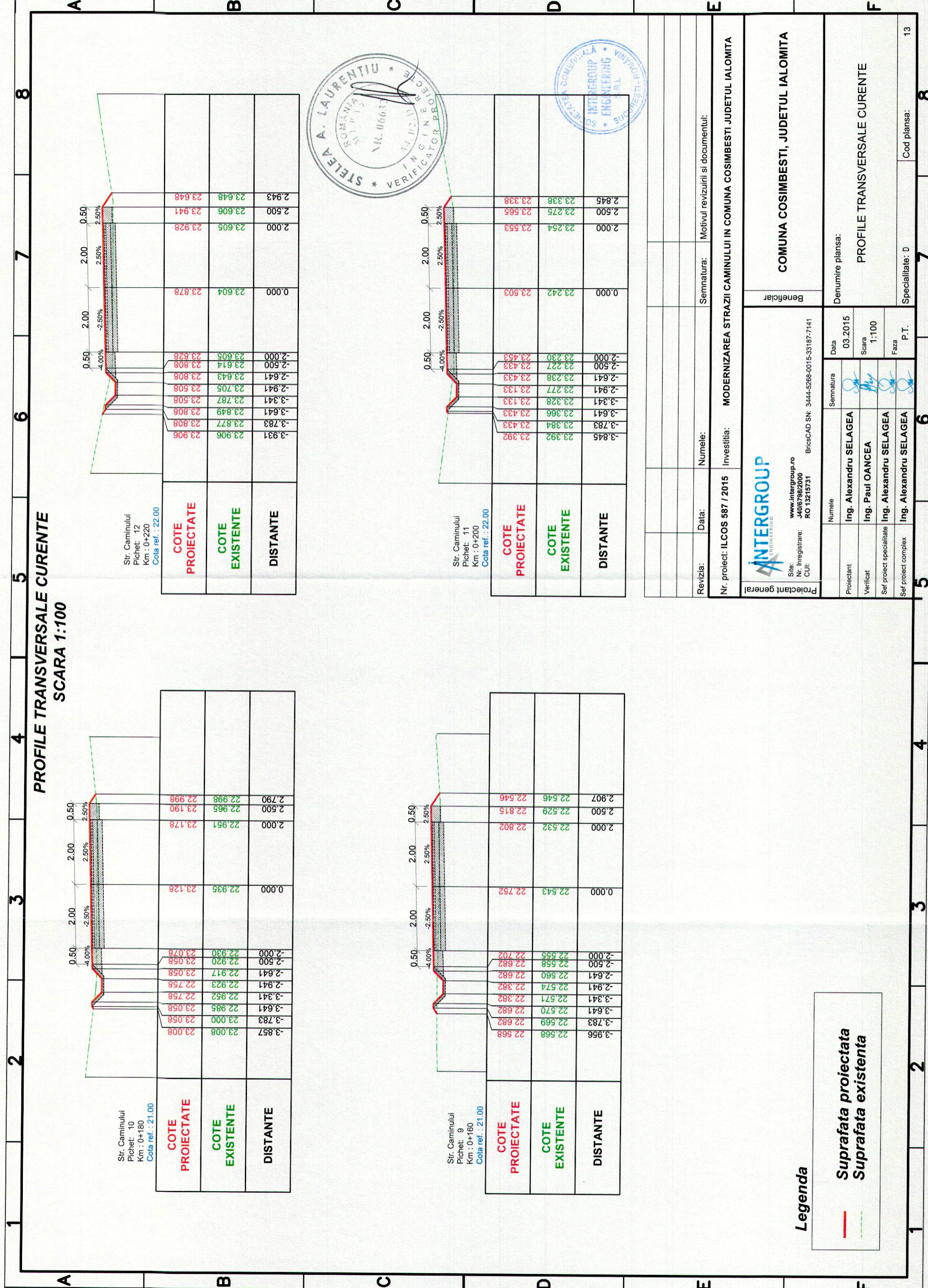

Str. Caminului
Pichet: 10
Km : 0+180
Cota ref. : 21.00

COTE PROIECTATE	23.008	23.058	23.058	22.758	22.758	22.941	-2.941	-2.641	-2.500	-2.000	0.000	2.000	2.000	2.500	2.790
COTE EXISTENTE	23.008	23.058	23.058	22.923	22.923	22.917	22.920	22.930	22.935	22.951	23.178	23.190	22.998	22.965	2.790
DISTANTE	3.857	3.783	3.641	3.341	2.941	2.641	2.500	2.000	0.000	2.000	2.000	2.500	2.500	2.790	

Str. Caminului
Pichet: 9
Km : 0+160
Cota ref. : 21.00

COTE PROIECTATE	22.568	22.682	22.682	22.382	22.382	22.574	22.555	22.682	22.752	22.802	22.815	22.546	22.546	2.907
COTE EXISTENTE	22.568	22.682	22.682	22.382	22.382	22.574	22.555	22.682	22.752	22.802	22.815	22.546	22.546	2.907
DISTANTE	3.956	3.783	3.641	3.341	2.941	2.641	2.500	2.000	0.000	2.000	2.000	2.500	2.500	2.907

Str. Caminului
Pichet: 12
Km : 0+220
Cota ref. : 22.00

COTE PROIECTATE	23.906	23.808	23.808	23.508	23.508	23.705	23.614	23.808	23.878	23.928	23.941	23.648	2.943
COTE EXISTENTE	23.906	23.808	23.808	23.849	23.849	23.787	23.614	23.643	23.604	23.605	23.605	23.648	2.943
DISTANTE	3.931	3.783	3.641	3.341	2.941	2.641	2.500	2.000	0.000	2.000	2.000	2.500	2.943

Str. Caminului
Pichet: 11
Km : 0+200
Cota ref. : 22.00

COTE PROIECTATE	23.392	23.433	23.433	23.133	23.133	23.277	23.227	23.433	23.503	23.553	23.565	23.338	2.845
COTE EXISTENTE	23.392	23.433	23.433	23.328	23.328	23.277	23.227	23.433	23.503	23.553	23.565	23.338	2.845
DISTANTE	3.845	3.783	3.641	3.341	2.941	2.641	2.500	2.000	0.000	2.000	2.000	2.500	2.845

Legenda

— Suprafata proiectata
- - - Suprafata existenta

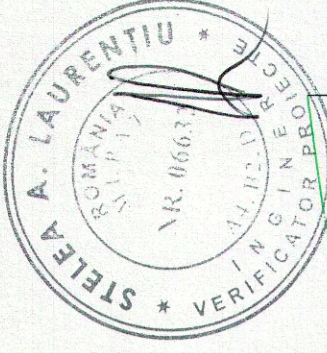

Revizia:	Data:	Numele:	Semnatura:	Motivul revizuirii si documentul:
Nr. proiect: ILCOS 587 / 2015	Investitia:	MODERNIZAREA STRAZII CAMINULUI IN COMUNA COSIMBESTI JUDETLUL IALOMITA		
Beneficiar				
COMUNA COSIMBESTI, JUDETLUL IALOMITA				
Denumire plansa:				
PROFILE TRANSVERSALE CURENTE				
Proiectant	Numele	Semnatura	Data	
Verificat	Ing. Alexandru SELAGEA		03.2015	
Sef proiect specialitate	Ing. Paul OANCEA		Scara	1:100
Sef proiect complex	Ing. Alexandru SELAGEA		Faza	P.T.
Cod plansa: D				
Specialitate: D				
13				

INTERGROUP
INGINIERIA

Site: www.intergroup.ro
Nr. Inregistrare: J48/2007/2010
CUI: RO 13215731

BricsCAD SN: 3444-5268-0015-33187-7141

**PROFILE TRANSVERSALE CURENTE
SCARA 1:100**

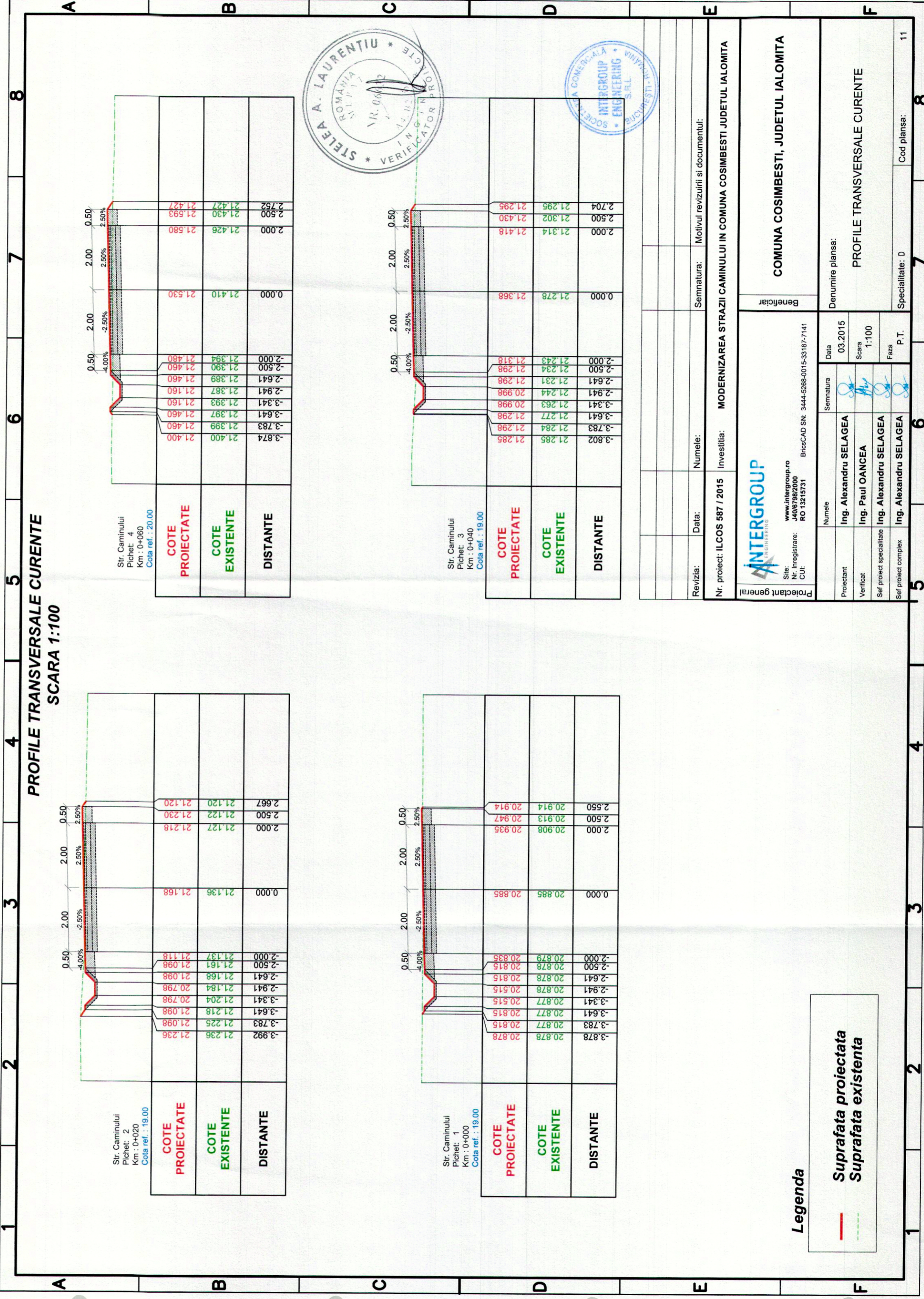

Str. Caminului
Pichet: 2
Km : 0+020
Cota ref. : 19.00

COTE PROIECTATE	21.236	21.098	21.098	21.098	20.798	20.798	21.184	21.168	21.136	21.127	21.230	21.120
COTE EXISTENTE	21.236	21.225	21.218	21.204	21.184	21.168	21.161	21.137	21.136	21.127	21.122	21.120
DISTANTE	-3.992	-3.783	-3.641	-3.341	-2.941	-2.641	-2.500	-2.000	0.000	2.000	2.500	2.667

Str. Caminului
Pichet: 4
Km : 0+060
Cota ref. : 20.00

COTE PROIECTATE	21.400	21.460	21.460	21.160	21.160	21.460	21.480	21.530	21.426	21.580	21.427	21.593
COTE EXISTENTE	21.400	21.399	21.397	21.393	21.387	21.389	21.394	21.410	21.426	21.426	21.430	21.430
DISTANTE	-3.874	-3.783	-3.641	-3.341	-2.941	-2.641	-2.000	0.000	2.000	2.000	2.500	2.752

Str. Caminului
Pichet: 1
Km : 0+000
Cota ref. : 19.00

COTE PROIECTATE	20.878	20.815	20.815	20.815	20.515	20.815	20.815	20.835	20.885	20.935	20.947	20.914
COTE EXISTENTE	20.878	20.877	20.877	20.877	20.878	20.878	20.878	20.879	20.885	20.908	20.913	20.914
DISTANTE	-3.878	-3.783	-3.641	-3.341	-2.941	-2.641	-2.500	-2.000	0.000	2.000	2.500	2.550

Str. Caminului
Pichet: 3
Km : 0+040
Cota ref. : 19.00

COTE PROIECTATE	21.285	21.298	21.298	20.998	21.298	21.298	21.318	21.368	21.314	21.418	21.295	21.430
COTE EXISTENTE	21.285	21.284	21.277	21.263	21.244	21.231	21.243	21.278	21.314	21.314	21.302	21.302
DISTANTE	-3.802	-3.783	-3.641	-3.341	-2.941	-2.641	-2.000	0.000	2.000	2.000	2.500	2.704

Legenda

- Suprafata proiectata
- - - Suprafata existenta



Revizia:	Data:	Numele:	Semnatura:	Motivul revizuirii si documentul:
Nr. proiect: ILCOS 587 / 2015 Investitia: MODERNIZAREA STRAZII CAMINULUI IN COMUNA COSIMBESTI JUDETEL IALOMITA				
Beneficiar COMUNA COSIMBESTI, JUDETEL IALOMITA				
Proiectant general INTERGROUP ENGINEERING Site: www.intergroup.ro Nr. Inregistrare: J406798/2000 CUI: RO 13215731 BricsCAD SN: 3444-5288-0015-33187-7141				
Proiectant	Numele	Semnatura	Data	Denumire plansa: PROFILE TRANSVERSALE CURENTE
Verificat	Ing. Alexandru SELAGEA		03.2015	
Ser proiect specialitate	Ing. Paul OANCEA		Scara 1:100	
Ser proiect complex	Ing. Alexandru SELAGEA		Faza P.T.	
Specialitate: D				Cod plansa: 11

STRADA CAMINULUI

PROFIL TRANSVERSAL TIP km 0+000 - km 0+450 Sc.1:50

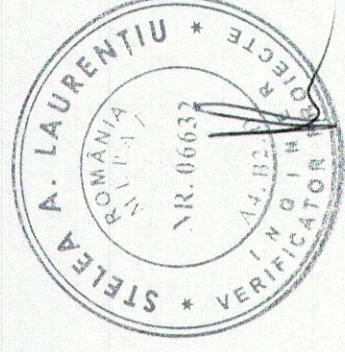
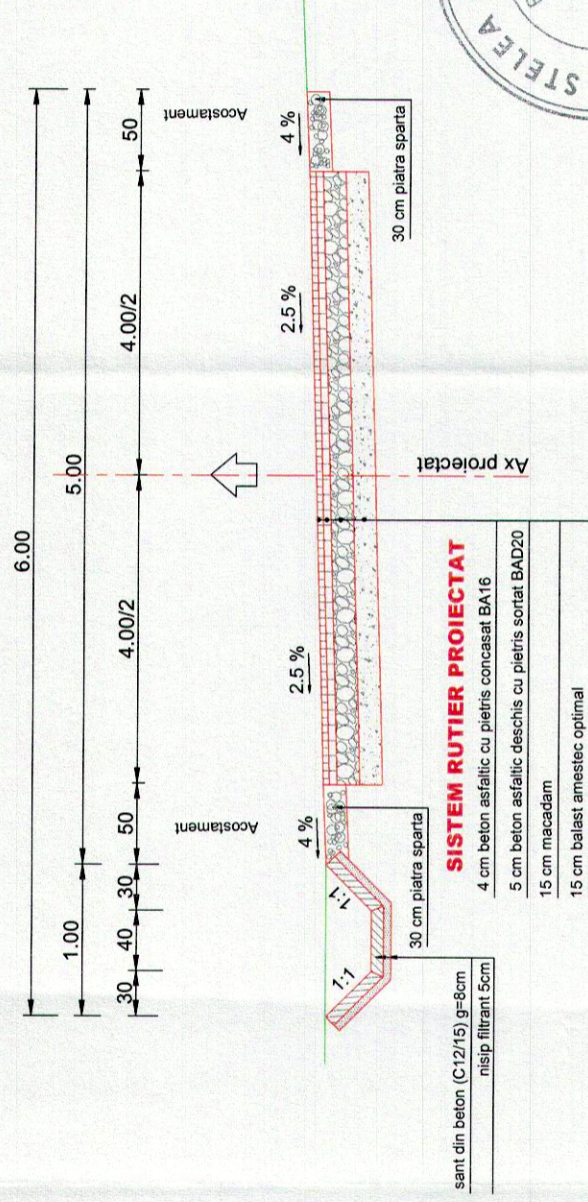

Revizia: _____ Data: _____ Numele: _____ Semnatura: _____ Motivul revizurii si documentul: _____

Nr. proiect: ILCOS 587 / 2015 Investitia: MODERNIZAREA STRAZII CAMINULUI IN COMUNA COSIMBESTI JUDETLUL IALOMITA

INTERGROUP
INGINERIE

Site: www.intergroup.ro
Nr. Inregistrare: J40/6798/2000
CUI: RO 13218731 BircCAD SN: 3444-5268-0015-33187-7141

Beneficiar

Beneficiar: COMUNA COSIMBESTI, JUDETLUL IALOMITA

Numele	Semnatura	Data
Proiectant Ing. Alexandru SELAGEA		04.2015
Verificat Ing. Paul OANCEA		Scara 1:50
Ser proiect specialitate Ing. Alexandru SELAGEA		Faza PT
Ser proiect complex Ing. Alexandru SELAGEA		

Denumire plansa:

PLAN DE INCADRARE IN ZONA

Specialitate: D

Cod plansa: 10

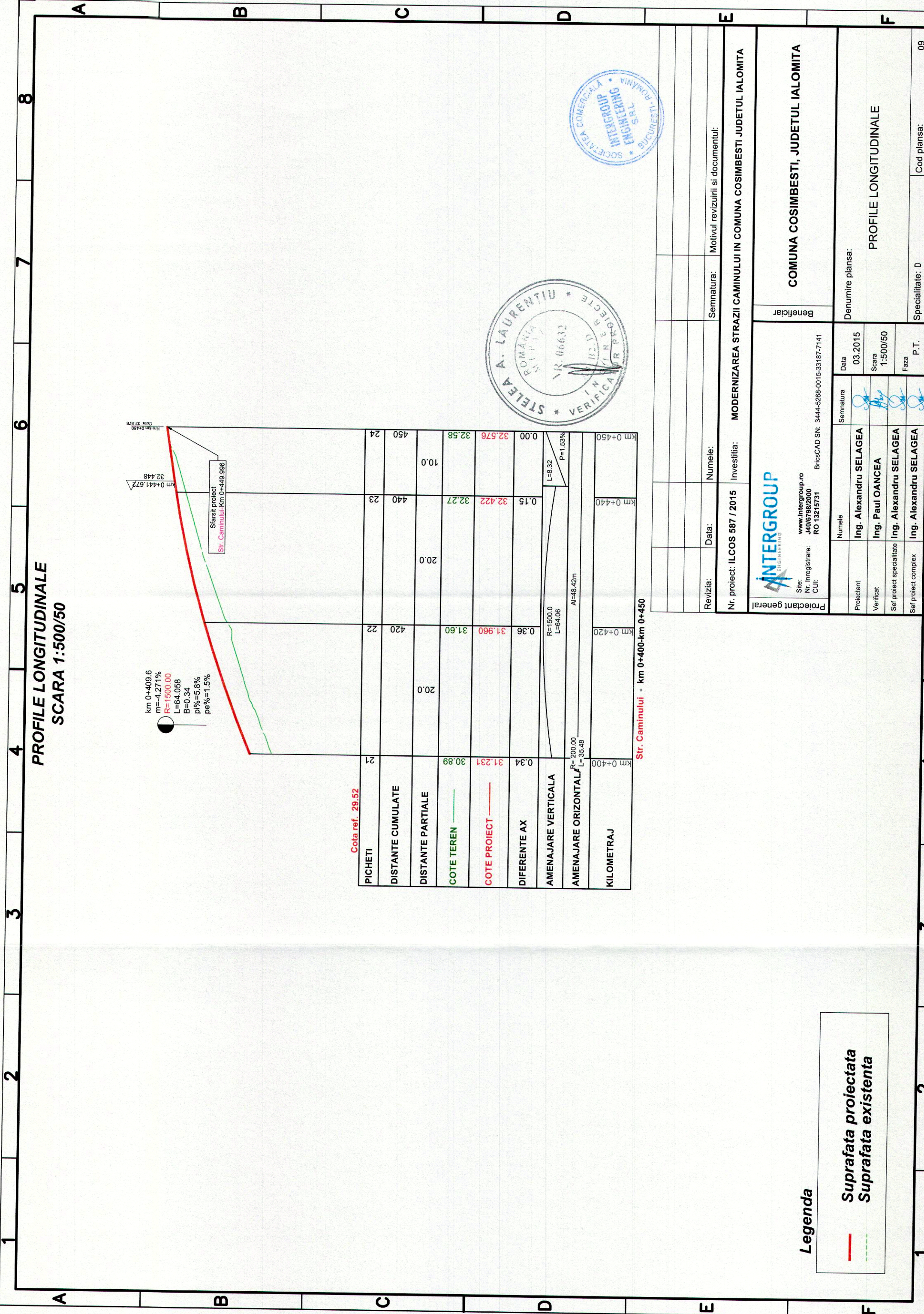

**PROFILE LONGITUDINALE
SCARA 1:500/50**

km 0+409.6
m=-4.271%
R=1500.00
L=64.058
B=0.34
p%=5.8%
pe%=1.5%

Sfarsit proiect
Str. Caminului - Km 0+449.996

Cota ref. 29.52

PICHETI	21	22	23	24	km 0+400	km 0+420	km 0+440	km 0+450
DISTANTE CUMULATE		420	440	450				
DISTANTE PARTIALE	20.0	20.0	10.0					
COTE TEREN	30.89	31.60	32.27	32.58				
COTE PROIECT	31.231	31.960	32.422	32.576				
DIFERENTE AX	0.34	0.36	0.15	0.00				
AMENAJARE VERTICALA	R=200.00 L=35.48	R=1500.0 L=64.06						
AMENAJARE ORIZONTALA		Al=+8.42m						
KILOMETRAJ	km 0+400	km 0+420	km 0+440	km 0+450				

Str. Caminului - km 0+400-km 0+450

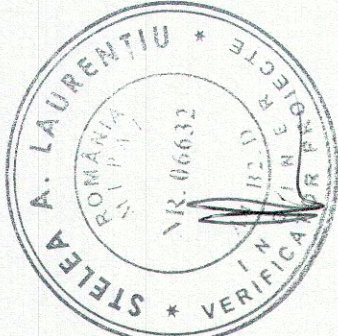

Legenda
 — Suprafata proiectata
 - - - Suprafata existenta

Revizia:	Data:	Numele:	Semnatura:	Motivul revizuirii si documentul:
Nr. proiect: ILCOS 587 / 2015		Investitia: MODERNIZAREA STRAZII CAMINULUI IN COMUNA COSIMBESTI JUDETLUL IALOMITA		
Proiectant general: Sire: J406798/2000 Nr. Inregistrare: RO 13215731 CUI: BricCAD SN: 3444-5268-0015-33187-7141				
Beneficiar		COMUNA COSIMBESTI, JUDETLUL IALOMITA		
Denumire plansa:		PROFILE LONGITUDINALE		
Data		03.2015		
Scara		1:500/50		
Faza		P.T.		
Specialitate: D		Cod plansa: 09		

**PROFILE LONGITUDINALE
SCARA 1:500/50**

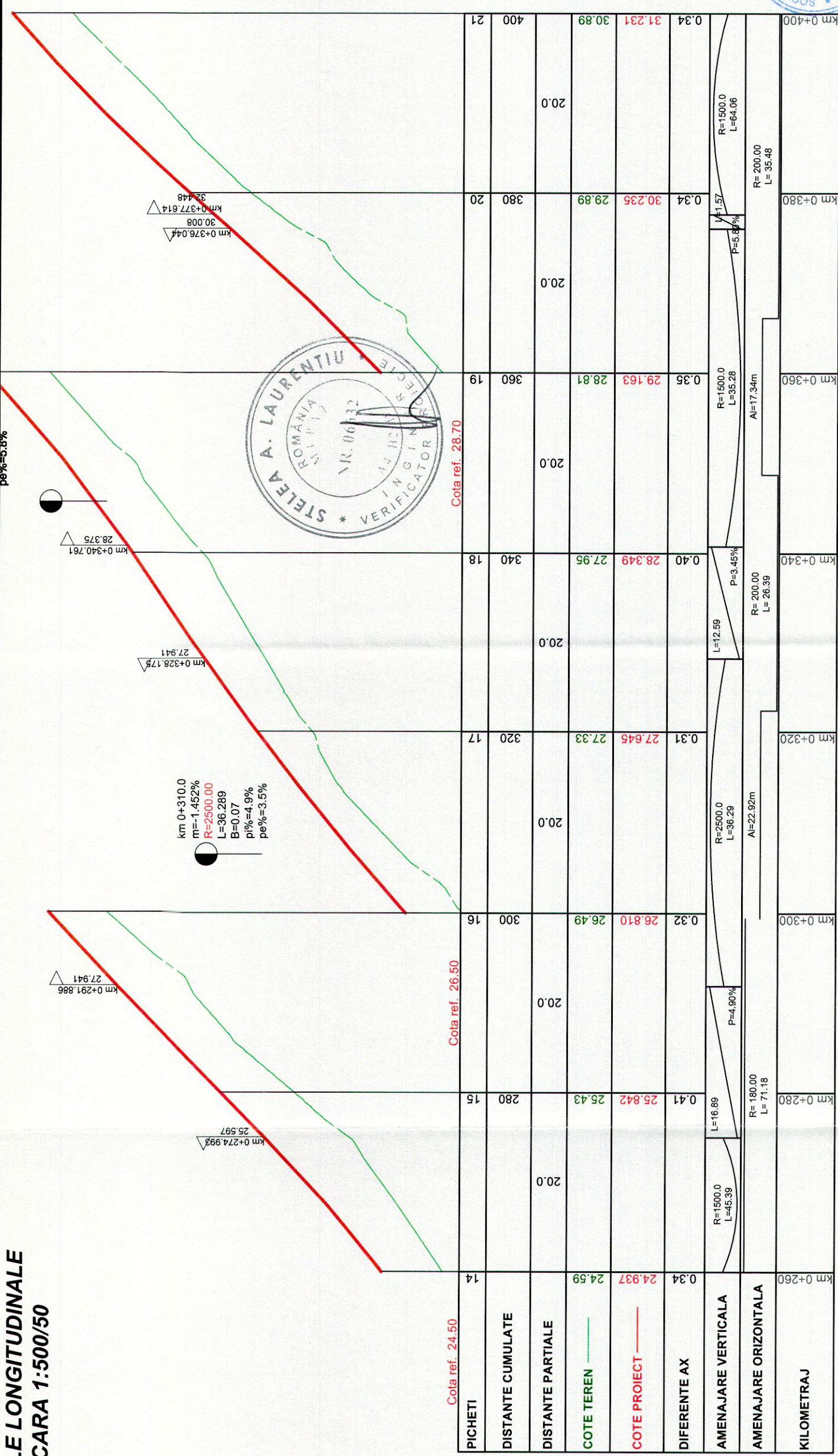

PICHETI	14	15	16	17	18	19	20	21
DISTANTE CUMULATE		280	300	320	340	360	380	400
DISTANTE PARTIALE	20.0	20.0	20.0	20.0	20.0	20.0	20.0	20.0
COTE TEREN	24.59	25.43	26.49	27.33	27.95	28.81	29.89	30.89
COTE PROIECT	24.937	25.842	26.810	27.645	28.349	29.163	30.235	31.231
DIFERENTE AX	0.34	0.41	0.32	0.31	0.40	0.35	0.34	0.34
AMENAJARE VERTICALA	R=1500.0 L=45.39	R=1500.0 L=71.18	R=2500.0 L=36.29	R=2500.0 L=36.29	R=200.00 L=26.39	R=1500.0 L=35.28	R=200.00 L=35.48	R=1500.0 L=64.06
AMENAJARE ORIZONTALA			AI=22.92m	AI=22.92m	AI=17.34m	AI=17.34m		
KILOMETRAJ	km 0+260	km 0+280	km 0+300	km 0+320	km 0+340	km 0+360	km 0+380	km 0+400

Str. Caminului - Km 0+260-km 0+400

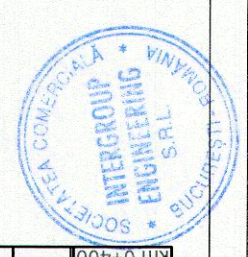

Revizia:	Data:	Numele:	Semnatura:	Motivul revizuirii si documentul:
Nr. proiect: ILCOS 587 / 2015 Investitia: MODERNIZAREA STRAZII CAMINULUI IN COMUNA COSIMBESTI JUDETEL IALOMITA				
Proiectant general: INTERGROUP ENGINEERING				
Site: www.intergroup.ro				
Nr. Inregistrare: J40/6798/2000				
CUI: RO 13215731				
BricsCAD SN: 3444-5268-0015-33187-7141				
Proiectant	Numele	Semnatura	Data	
Verificat	Ing. Alexandru SELAGEA		03.2015	
Sef proiect specialitate	Ing. Paul OANCEA		Scara 1:500/50	
Sef proiect complex	Ing. Alexandru SELAGEA		Faza P.T.	
Denumire plansa: PROFILE LONGITUDINALE				Cod plansa: 08

Legenda

- Suprafata proiectata
- - - Suprafata existenta

PROFILE LONGITUDINALE
SCARA 1:500/50

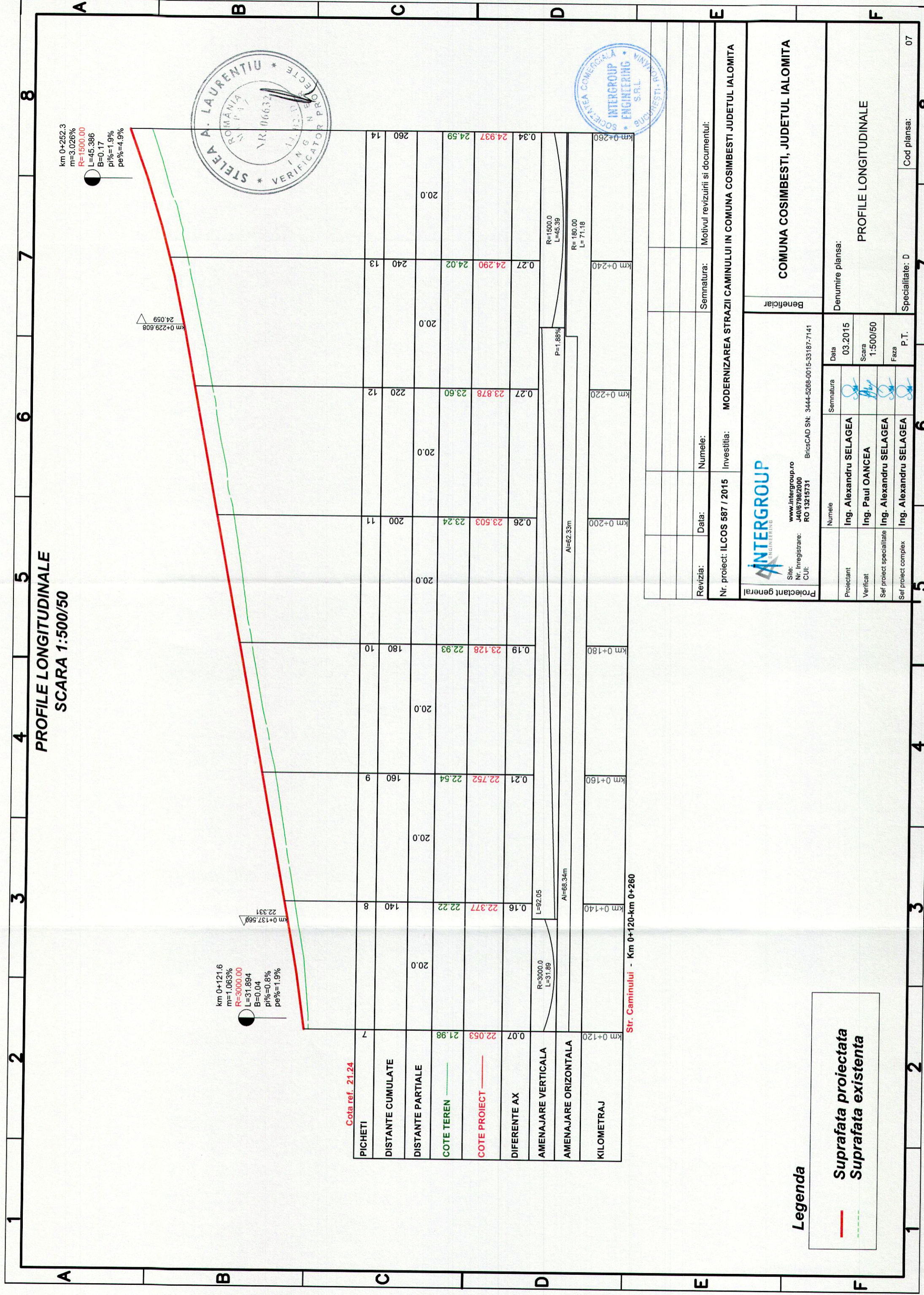

km 0+121.6
m=1.063%
R=3000.00
L=31.884
B=0.04
pl%=0.8%
pe%=1.9%

km 0+229.608
24.059

km 0+252.3
m=3.026%
R=1800.00
L=45.386
B=0.17
pl%=1.9%
pe%=4.9%

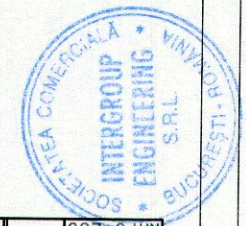
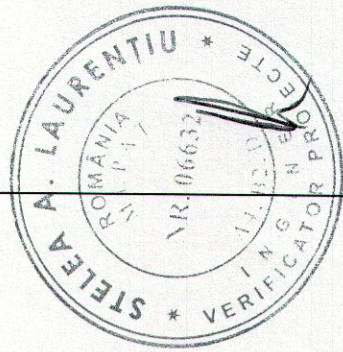

PICHETI	7	8	9	10	11	12	13	14
DISTANTE CUMULATE	0.07	0.16	0.21	0.19	0.26	0.27	0.27	0.34
DISTANTE PARTIALE	20.0	20.0	20.0	20.0	20.0	20.0	20.0	20.0
COTE TEREN	21.98	22.22	22.54	22.93	23.24	23.60	24.02	24.59
COTE PROIECT	22.053	22.377	22.752	23.128	23.503	23.878	24.290	24.937
DIFERENTE AX	0.07	0.16	0.21	0.19	0.26	0.27	0.27	0.34
AMENAJARE VERTICALA	R=3000.0 L=31.89	L=92.05						R=1500.0 L=45.39
AMENAJARE ORIZONTALA	Al=98.34m	Al=62.33m						R=180.00 L=71.18
KILOMETRAJ	km 0+120	km 0+140	km 0+160	km 0+180	km 0+200	km 0+220	km 0+240	km 0+260

Str. Caminului - Km 0+120-km 0+260

Legenda
— Suprafata proiectata
- - - Suprafata existenta

Revizia:	Data:	Numele:	Semnatura:	Motivul revizurii si documentul:
Nr. proiect: ILCOS 587 / 2015	Investitia:	MODERNIZAREA STRAZII CAMINULUI IN COMUNA COSIMBESTI JUDEȚUL IALOMITA		
 Proiectant general Site: www.intergroup.ro Nr. Inregistrare: J406798/2000 CUI: RO 13215731 BricCAD SN: 3444-5268-0015-33187-7141				
Proiectant	Numele	Semnatura	Data	
Verificat	Ing. Alexandru SELAGEA		03.2015	
Sef proiect specialitate	Ing. Paul OANCEA		Scara 1:500/50	
Sef proiect complex	Ing. Alexandru SELAGEA		Faza	
	Ing. Alexandru SELAGEA		P.T.	
Beneficiar			COMUNA COSIMBESTI, JUDEȚUL IALOMITA	
Denumire plansa:			PROFILE LONGITUDINALE	
Specialitate: D			Cod plansa: 07	

**PROFILE LONGITUDINALE
SCARA 1:500/50**

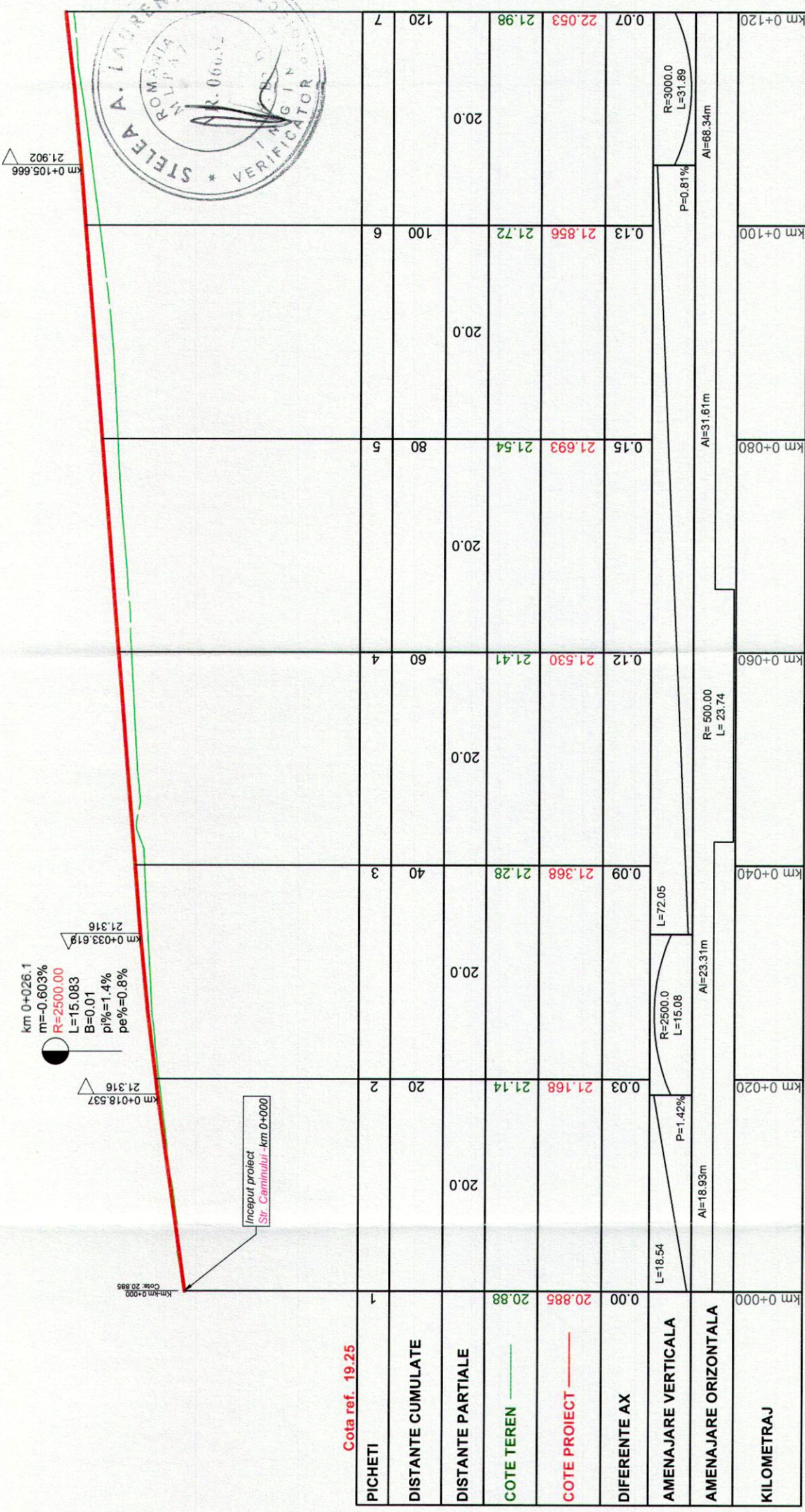

PICHETI	1	2	3	4	5	6	7	
DISTANTE CUMULATE		20	40	60	80	100	120	
DISTANTE PARTIALE	20.0	20.0	20.0	20.0	20.0	20.0	20.0	
COTE TEREN	20.88	21.14	21.28	21.41	21.54	21.72	21.98	
COTE PROIECT	20.885	21.168	21.368	21.530	21.693	21.856	22.053	
DIFERENTE AX	0.00	0.03	0.09	0.12	0.15	0.13	0.07	
AMENAJARE VERTICALA	L=18.54	P=1.42%	R=2500.0 L=15.08	L=72.05	R=500.00 L=23.74	Al=31.61m	P=0.81%	R=3000.0 L=31.89
AMENAJARE ORIZONTALA	Al=18.93m	Al=23.31m	Al=23.31m	Al=31.61m	Al=68.34m			
KILOMETRAJ	km 0+000	km 0+020	km 0+040	km 0+060	km 0+080	km 0+100	km 0+120	

Str. Caminului - Km 0+000-km 0+120

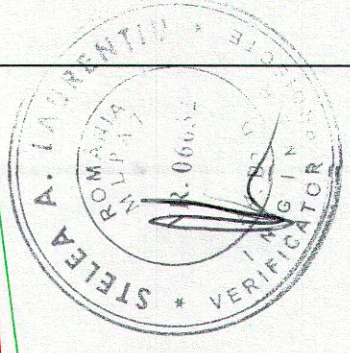

Revizia: Data: Numele: Semnatura: Motivul revizuirii si documentul:

Nr. proiect: ILCOS 587 / 2015 Investitia: MODERNIZAREA STRAZII CAMINULUI IN COMUNA COSIMBESTI JUDETEL IALOMITA



Site: www.intergroup.ro
Nr. Inregistrare: J406798/2000
CUI: RO 13215731
BricsCAD SN: 3444-5268-0015-33187-7141

Proiectant general		Beneficiar	
Numele	Semnatura	Data	
Ing. Alexandru SELAGEA		03.2015	
Verificat	Ing. Paul OANCEA	Scara 1:500/50	
Sef proiect specialitate	Ing. Alexandru SELAGEA	Faza P.T.	
Sef proiect complex	Ing. Alexandru SELAGEA		

Legenda

— Suprafata proiectata
- - - Suprafata existenta

Specialitate: D Cod plansa: 06

PLAN DE SITUATIE
SCARA 1:500

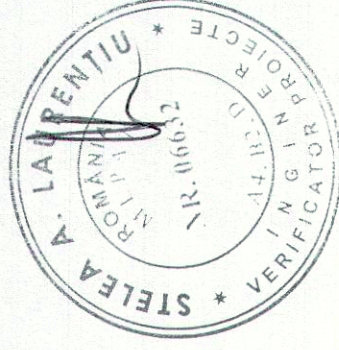
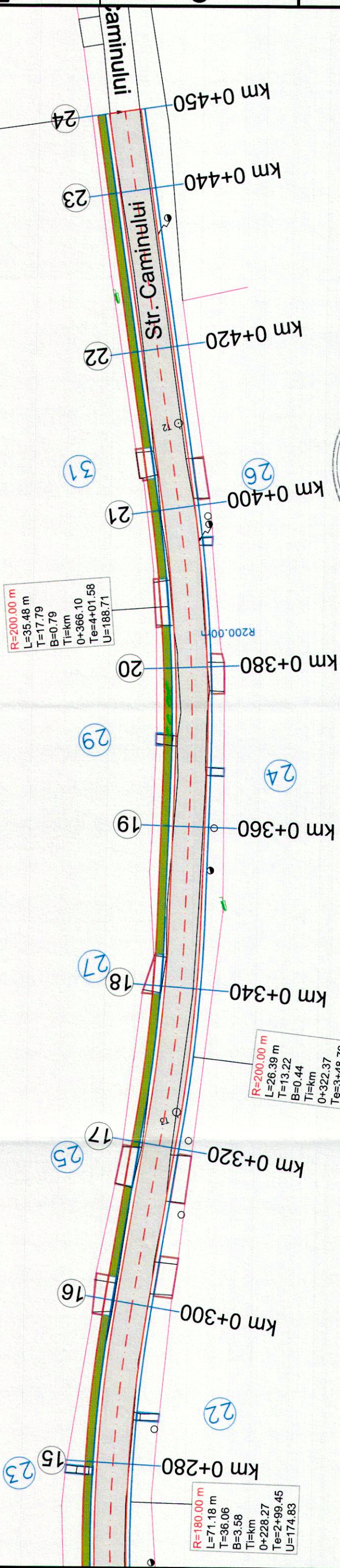

km

Revizia:	Data:	Numele:	Semnatura:	Motivul revizurii si documentul:
Nr. proiect: ILCOS 587 / 2015	Investitia: MODERNIZAREA STRAZII CAMINULUI IN COMUNA COSIMBESTI JUDETELUL IALOMITA			
INTERGROUP ENGINEERING Site: www.intergroup.ro Nr. Inregistrare: J406798/2000 CUI: RO 13215731 BricCAD SN: 3444-5269-0015-33187-7141				
Proiectant general	Beneficiar			
Proiectant	Numele	Semnatura	Data	Denumire planşa:
Verificat	Ing. Alexandru SELAGEA		03.2015	PLAN DE SITUATIE
Sef proiect specialitate	Ing. Paul OANCEA		Scara 1:500	
Sef proiect complex	Ing. Alexandru SELAGEA		Faza P.T.	
				Specialitate: D
				Cod planşa: 05

Legenda

- Punct de statie
- Pom / copac
- Stalp din lemn
- Stalp din beton pentru iluminat
- Stalp din beton
- Cistea
- Camin vizitare retea apa
- Limita proprietate
- Margine drum
- Ax drum
- Acces proprietate

Legenda

- AX PROIECTAT
- MARGINE CAROSABIL PROIECTAT
- MARGINE ACOSTAMENT PROIECTAT
- SANT DE BETON
- RIGOLA CAROSABILA
- ACCES CAROSABIL IN CURTI PESTE SANT
- ACCES PIETONAL IN CURTI PESTE SANT
- ACCES CAROSABIL
- ACCES PIETONAL

1 2 3 4 5 6 7 8

A B C D E F

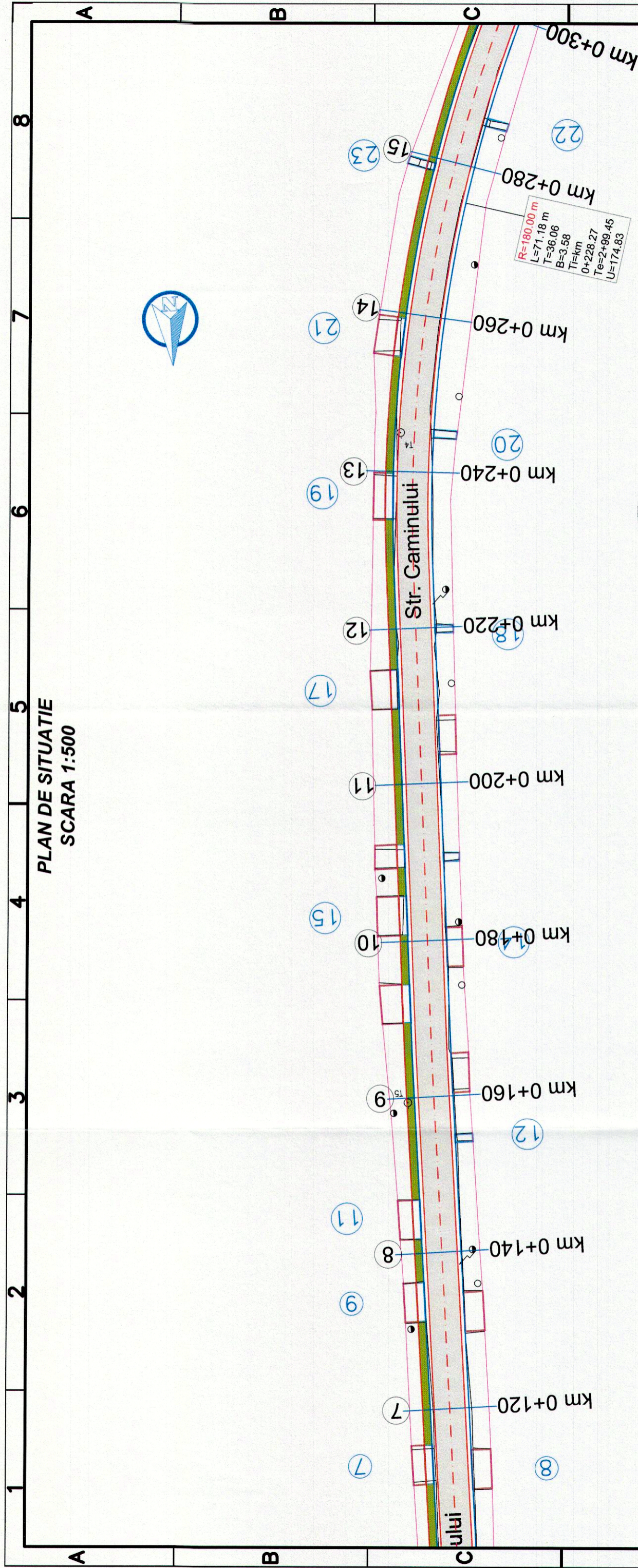

PLAN DE SITUATIE
SCARA 1:500

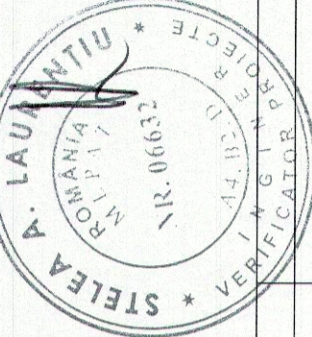

Legenda

	Punct de statie
	Pom / copac
	Stalp din lemn
	Stalp din beton
	pentru iluminat
	Stalp din beton
	Cisnea
	Camin vizitare
	retea apa
	Limita proprietate
	Margine drum
	Ax drum
	Acces proprietate

Legenda

	AX PROIECTAT
	MARGINE CAROSABIL PROIECTAT
	MARGINE ACOSTAMENT PROIECTAT
	SANT DE BETON
	RIGOLA CAROSABILA
	ACCES CAROSABIL IN CURTI PESTE SANT
	ACCES PIETONAL IN CURTI PESTE SANT
	ACCES CAROSABIL
	ACCES PIETONAL

Revizia:	Data:	Numele:	Semnatura:	Motivul revizuirii si documentul:
Nr. proiect: ILCOS 587 / 2015	Investitia: MODERNIZAREA STRAZII CAMINULUI IN COMUNA COSIMBESTI JUDETEL IALOMITA			
<p>INTERGROUP ENGINEERING Site: www.intergroup.ro Nr. Inregistrare: J406798/2000 CUI: RO 13215731 BricCAD SN: 3444-5268-0015-33187-7141</p>				
<p>STELIA A. LAURANTIU ROMANIA Nr. 06632 VERIFICATOR</p>				
Proiectant general		Beneficiar		
Proiectant	Numele	Semnatura	Data	
Verificat	Ing. Alexandru SELAGEA		03.2015	
Sef proiect specialitate	Ing. Paul OANCEA		Scara	1:500
Sef proiect complex	Ing. Alexandru SELAGEA		Faza	P.T.
				Specialitate: D
				Cod plansa: 04

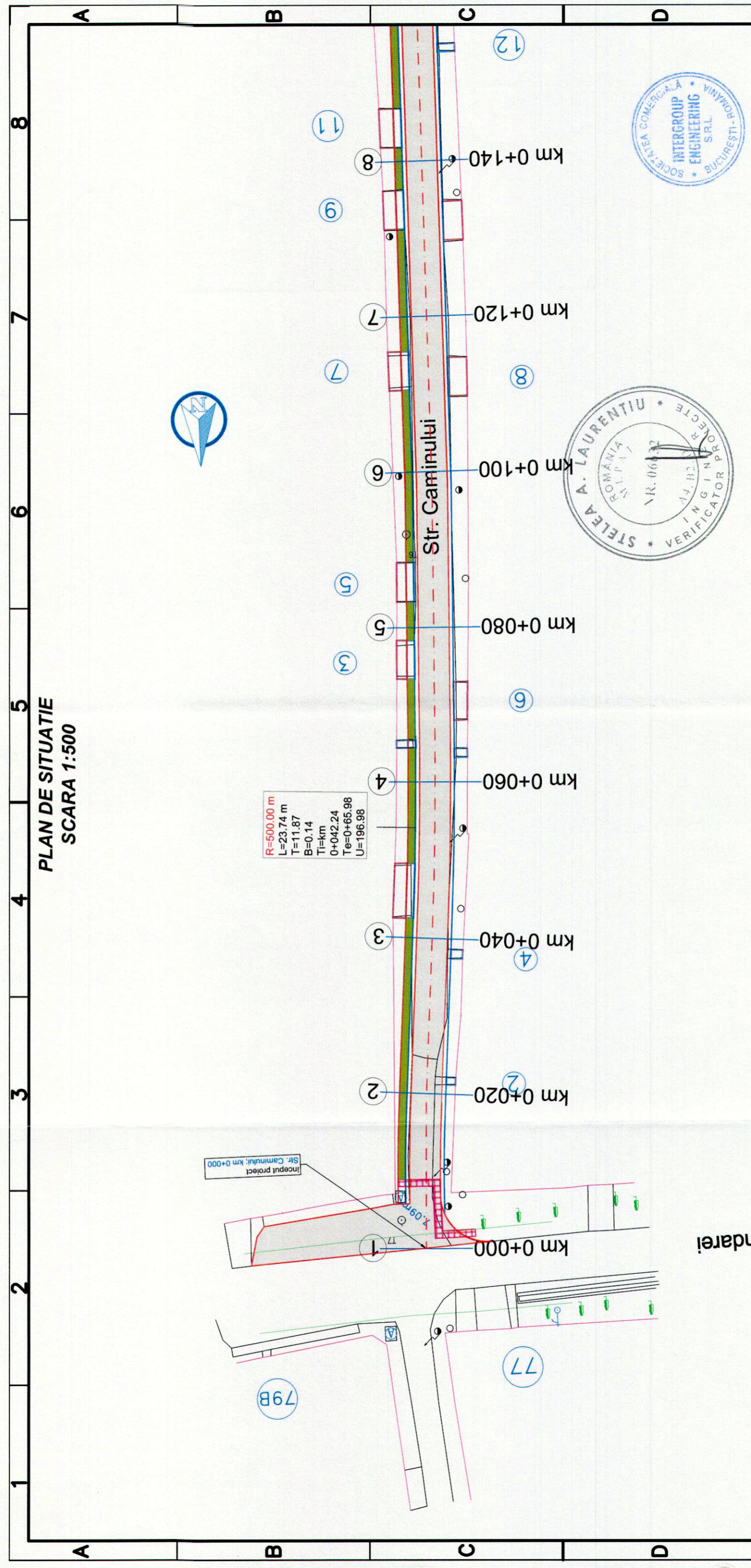

**PLAN DE SITUATIE
SCARA 1:500**

R=500.00 m
L=23.74 m
T=11.87
B=0.14
TI=km
O=0+042.24
Te=0+065.98
U=196.98

Legenda

- Punct de statie
- Pom / copac
- Stalp din lemn
- Stalp din beton
- pentru iluminat
- Stalp din beton
- Cismea
- Camin vizitare
- retea apa
- Limita proprietate
- Margine drum
- Ax drum
- Acces proprietate

Legenda

- AX PROIECTAT
- MARGINE CAROSABIL PROIECTAT
- MARGINE ACOSTAMENT PROIECTAT
- SANT DE BETON
- RIGOLA CAROSABILA
- ACCES CAROSABIL IN CURTI PESTE SANT
- ACCES PIETONAL IN CURTI PESTE SANT
- ACCES CAROSABIL
- ACCES PIETONAL

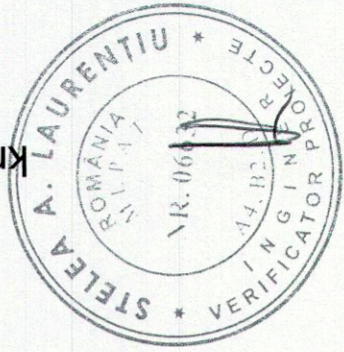

Revizia: _____ Data: _____ Numele: _____ Semnatura: _____ Motivul revizuirii si documentul: _____

Nr. proiect: ILCOS 587 / 2015		Investitia: MODERNIZAREA STRAZII CAMINULUI IN COMUNA COSIMBESTI, JUDETELUL IALOMITA	
		Beneficiar	
Site: www.intergroup.ro Nr. Inregistrare: J40/6798/2000 CUI: RO 13215731		Semnatura Data Scara Feza	
Proiectant	Ing. Alexandru SELAGEA	03.2015	
Verificat	Ing. Paul OANCEA	1:500	
Sef proiect specialitate	Ing. Alexandru SELAGEA	P.T.	
Sef proiect complex	Ing. Alexandru SELAGEA	Cod plansa: 03	

andarei

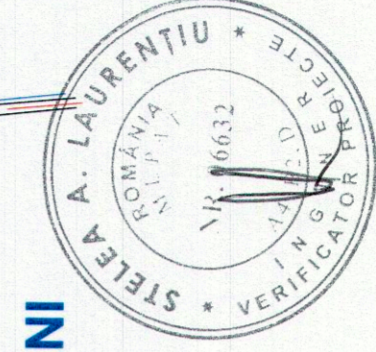
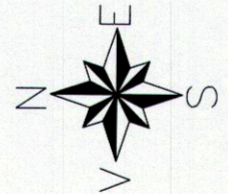

GIMBASANI

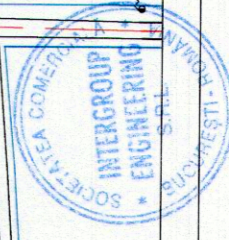

Revizia:	Data:	Numele:	Semnatura:	Motivul revizurii si documentului:
Nr. proiect: ILCOS 587 / 2015		Investitia: MODERNIZAREA STRAZII CAMINULUI IN COMUNA COSIMBESI JUDETEL IALOMITA		
Beneficiar				
COMUNA COSIMBESI, JUDETEL IALOMITA				
Denumire plansa:				
PLAN DE AMPLASAMENT STRADA CAMINULUI				
Data		04.2015		
Scara		1:2000		
Faza		P.T.		
Numele		Semnatura		
Ing. Alexandru SELAGEA				
Ing. Paul OANCEA				
Ing. Alexandru SELAGEA				
Ing. Alexandru SELAGEA				
Proiectant		Data		
Verificat		Scara		
Sef proiect specialitate		Faza		
Sef proiect complex		P.T.		
www.intergroup.ro		BriceCAD SN: 3444-5268-0015-33187-7141		
Nr. Inregistrare: J40/6798/2000				
CUI: RO 13215731				

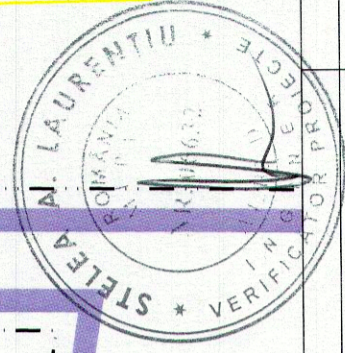
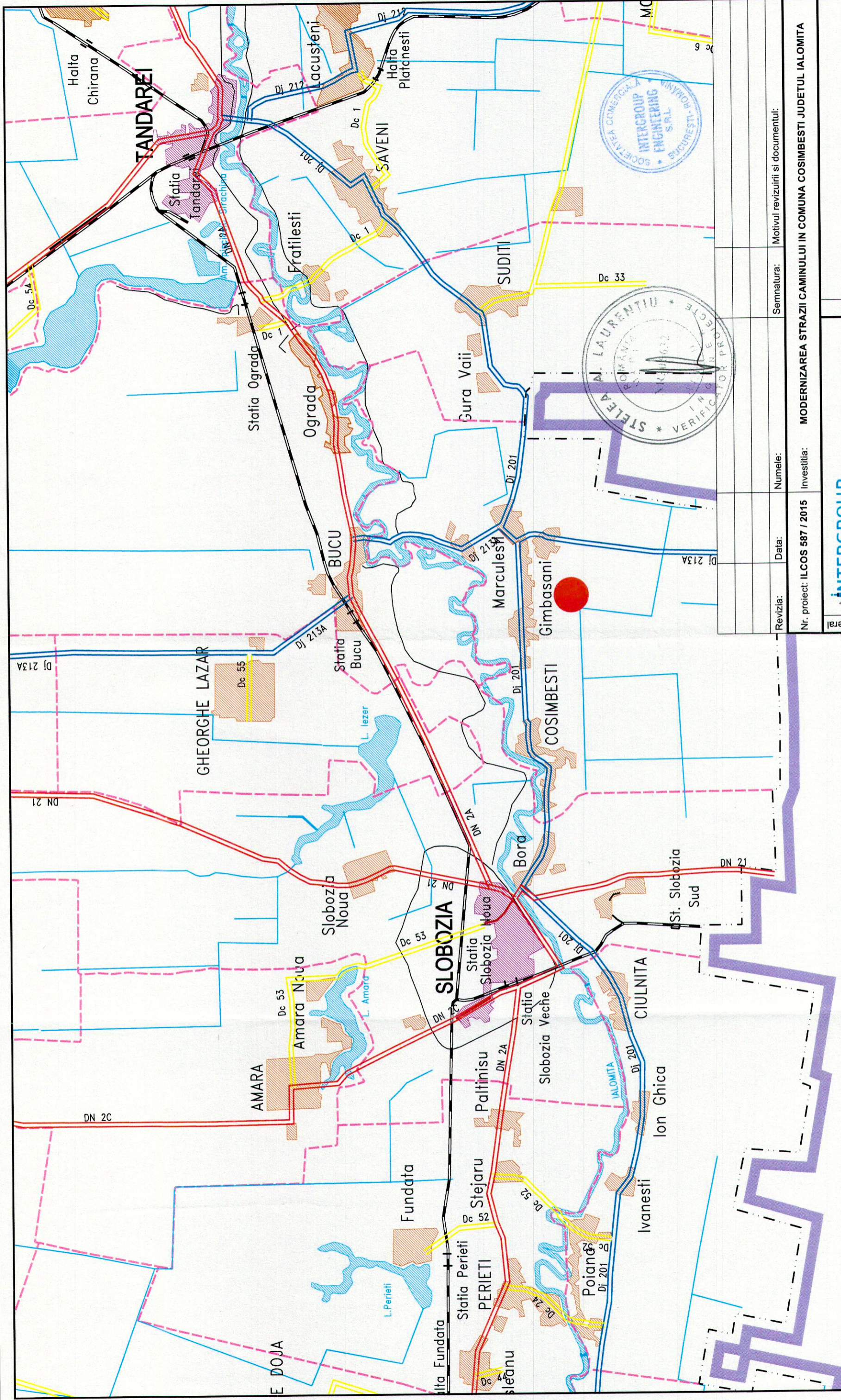

Revizua:	Data:	Numele:	Semnatura:	Motivul revizuirii si documentul:
Nr. proiect: ILCOS 587 / 2015	Investitia:	MODERNIZAREA STRAZII CAMINULUI IN COMUNA COSIMBESTI JUDETELUL IALOMITA		
Beneficiar				
COMUNA COSIMBESTI, JUDETELUL IALOMITA				
Denumire plansa:				
PLAN DE INCADRARE IN ZONA				
Data: 04.2015				
Scara: 1:100.000				
Faza: P.T.				
Specialitate: D				
Cod plansa: 01				

INTERGROUP
ENGINEERING S.R.L.

www.intergroup.ro
Nr. Inregistrare: J40/6798/2000
CUI: RO 13215731

BricsCAD SN: 3444-5268-0015-33187-7141

Proiectant	Ing. Alexandru SELAGEA
Verificat	Ing. Paul OANCEA
Sef proiect specialitate	Ing. Alexandru SELAGEA
Sef proiect complex	Ing. Alexandru SELAGEA

Proiectant general	Stelia N. Laurentiu
--------------------	---------------------